

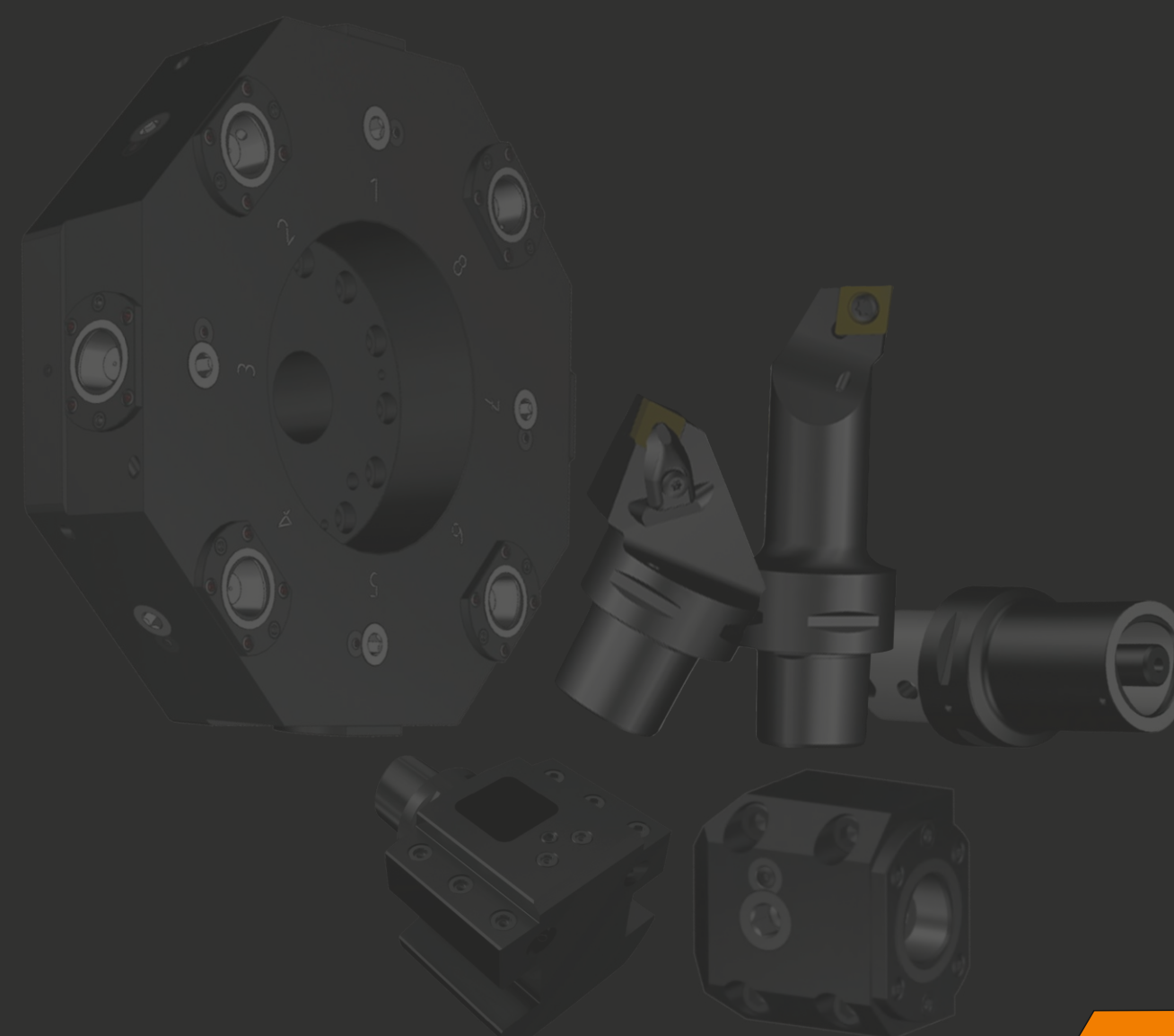

donray
metal cutting tools



donray
metal cutting tools



tt@ttoolz.ru
www.ttoolz.ru

+7 391 264-08-39
+7 391 223-16-63

г. Красноярск, 660079
ул. 60 лет Октября зд. 124м/1

PSC TURNING PRODUCT

EXTERNAL TURNING TOOL BODY

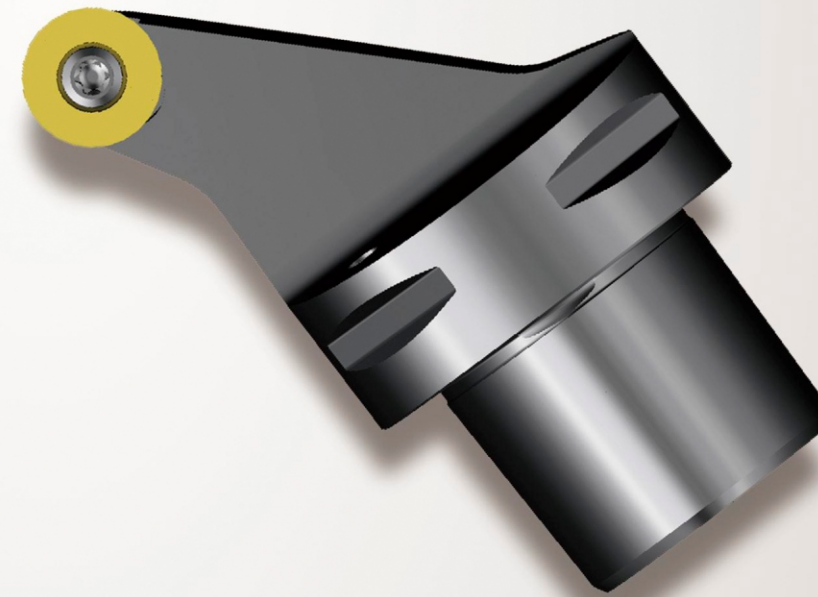

- For turning the external of the workpiece;
- Three clamping types, available in rough machining, semi-finishing, finishing machining;
- Out-machine tool adjustment, can be used in automatic mechanical equipment;
- Match the ISO standard insert on the market;
- Support non-standard customization.

TOOLING ALSO ARTS

D - 00

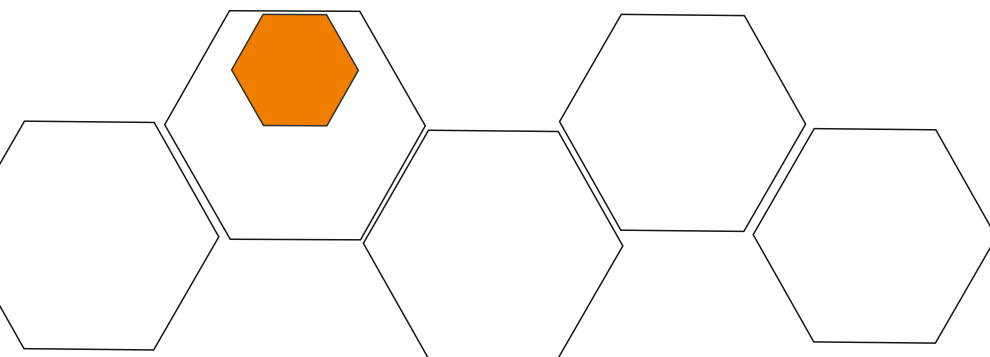

DCLNR/L-Kr 95°

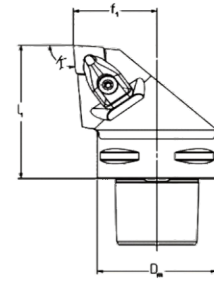
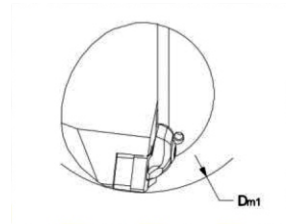
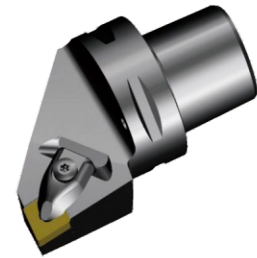

● CNMM CNMG CNMA CNGA

● CNMM CNMG CNMA CNGA
● The insert is for illustration only

Technical parameters

Unit: mm

(Kr)-Application	Ordering code	Dm	Dm1	f1	l1	γ	λ	m (kg)	ISO insert	
95°	12 PSC32-DCLNR-22045-12	32	60	22	45	-6°	-6°	0.2	CN.. 1204..	
	12 PSC32-DCLNL-22045-12	32	60	22	45	-6°	-6°	0.2		
	12 PSC40-DCLNR-27050-12	40	110	27	50	-6°	-6°	0.37		
	12 PSC40-DCLNL-27050-12	40	110	27	50	-6°	-6°	0.37		
	12 PSC50-DCLNR-35060-12	50	110	35	60	-6°	-6°	0.7		
	12 PSC50-DCLNL-35060-12	50	110	35	60	-6°	-6°	0.7		
	12 PSC63-DCLNR-45065-12	63	110	45	65	-6°	-6°	1.2		
	12 PSC63-DCLNL-45065-12	63	110	45	65	-6°	-6°	1.2		
	12 PSC80-DCLNR-55080-12	80	110	55	80	-6°	-6°	2.62		
	12 PSC80-DCLNL-55080-12	80	110	55	80	-6°	-6°	2.62		
	16 PSC40-DCLNR-27055-16	40	125	27	55	-6°	-6°	0.4		CN.. 1606..
	16 PSC40-DCLNL-27055-16	40	125	27	55	-6°	-6°	0.4		
16 PSC50-DCLNR-35060-16	50	125	35	60	-6°	-6°	0.7			
16 PSC50-DCLNL-35060-16	50	125	35	60	-6°	-6°	0.7			
16 PSC63-DCLNR-45065-16	63	125	45	65	-6°	-6°	1.2			
16 PSC63-DCLNL-45065-16	63	125	45	65	-6°	-6°	1.2			
16 PSC80-DCLNR-55080-16	80	125	55	80	-6°	-6°	2.44			
16 PSC80-DCLNL-55080-16	80	125	55	80	-6°	-6°	2.44			

D - 01

TOOLING ALSO ARTS

DCLNR/L-Kr 95°

Technical parameters

Unit: mm

(Kr)-Application	Ordering code	Dm	Dm1	f1	l1	γ	λ	m (kg)	ISO insert
95°	19 PSC50-DCLNR-35060-19	50	80	35	60	-6°	-6°	0.7	CN.. 1906..
	19 PSC50-DCLNL-35060-19	50	80	35	60	-6°	-6°	0.7	
	19 PSC63-DCLNR-45065-19	63	81	45	65	-6°	-6°	1.2	
	19 PSC63-DCLNL-45065-19	63	81	45	65	-6°	-6°	1.2	
	19 PSC80-DCLNR-55080-19	80	100	55	80	-6°	-6°	2.44	
	19 PSC80-DCLNL-55080-19	80	100	55	80	-6°	-6°	2.44	
	25 PSC80-DCLNR-55080-25	80	100	55	80	-6°	-6°	2.47	CN.. 2509..
	25 PSC80-DCLNL-55080-25	80	100	55	80	-6°	-6°	2.47	

Main spare parts

PSC size	Insert	Shim screw	Shim	Key	Complete clamp set
PSC32	12	ILD4085	322.236.03	248.150.10	412.028.021
PSC40-PSC80	12	ILD4085	322.234.01	248.150.10	412.028.021
PSC40-PSC80	16	ILD5011	322.234.03	248.200.10	412.028.031
PSC50-PSC80	19	ILD5011	322.236.01	248.200.10	413.028.041
PSC80	25	ILD6012	322.234.05	245.250.10	413.028.051

● The insert need to be ordered separately. Other accessories are included in the order.
● The spare parts can be ordered separately. Please inquire on demand.

TOOLING ALSO ARTS

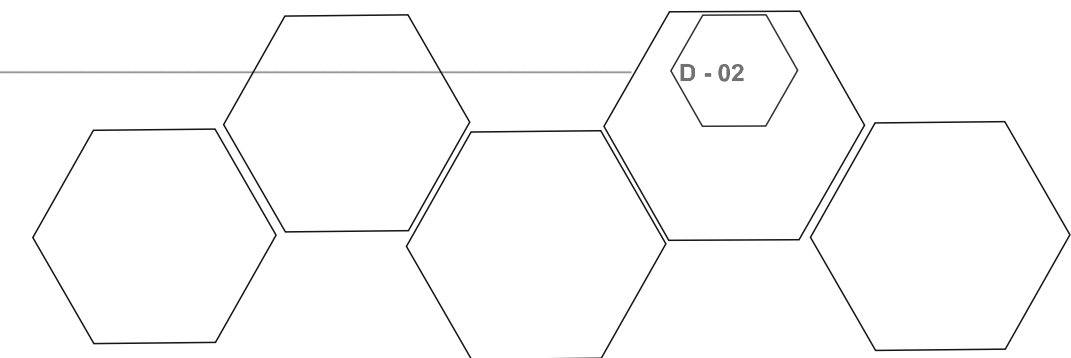

DDJNR/L-Kr 93° DDHNR/L-Kr 107.5° DDNNN-Kr 62.5°

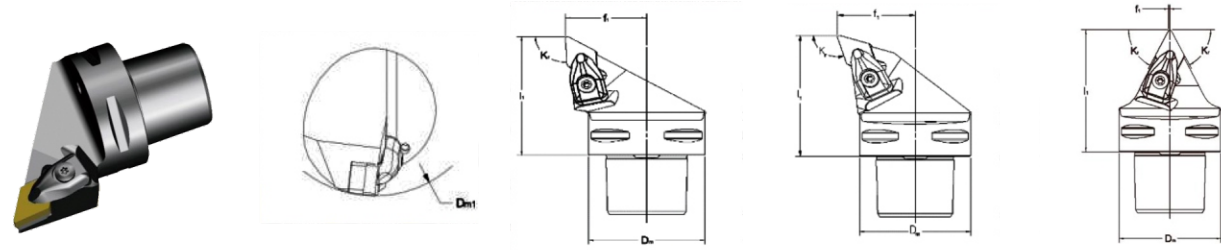

• DNMM DNMX DNMG DNMA DNMA

• DNMM DNMX DNMG DNMA DNMA
• The insert is for illustration only

Technical parameters

Unit: mm

(Kr)-Application	Ordering code	Dm	Dm1	f1	l1	γ	λ	m (kg)	ISO insert
93°	11 PSC32-DDJNR-22045-11	32	60	22	45	-6°	-7°	0.19	DN.. 1104..
	11 PSC32-DDJNL-22045-11	32	60	22	45	-6°	-7°	0.19	
	11 PSC40-DDJNR-27050-11	40	60	27	50	-6°	-7°	0.34	
	11 PSC40-DDJNL-27050-11	40	60	27	50	-6°	-7°	0.34	
	11 PSC50-DDJNR-35060-11	50	65	35	60	-6°	-7°	0.65	
	11 PSC50-DDJNL-35060-11	50	65	35	60	-6°	-7°	0.65	
	11 PSC63-DDJNR-45065-11	63	81	45	65	-6°	-7°	1.08	
	11 PSC63-DDJNL-45065-11	63	81	45	65	-6°	-7°	1.08	
107.5°	15 PSC40-DDJNR-27055-15	40	110	27	55	-6°	-7°	0.36	DN.. 1506..
	15 PSC40-DDJNL-27055-15	40	110	27	55	-6°	-7°	0.36	
	15 PSC50-DDJNR-35060-15	50	110	35	60	-6°	-7°	0.36	
	15 PSC50-DDJNL-35060-15	50	110	35	60	-6°	-7°	0.36	
	15 PSC63-DDJNR-45065-15	63	110	45	65	-6°	-7°	1.05	
	15 PSC63-DDJNL-45065-15	63	110	45	65	-6°	-7°	1.05	
	15 PSC80-DDJNR-55080-15	80	110	55	80	-6°	-7°	2.16	
	15 PSC80-DDJNL-55080-15	80	110	55	80	-6°	-7°	2.16	

D - 03

TOOLING ALSO ARTS

DDJNR/L-Kr 93° DDHNR/L-Kr 107.5° DDNNN-Kr 62.5°

Technical parameters

Unit: mm

(Kr)-Application	Ordering code	Dm	Dm1	f1	l1	γ	λ	m (kg)	ISO insert
107.5°	15 PSC40-DDHNR-27055-15	40	110	27	55	-6°	-7°	0.38	DN.. 1506..
	15 PSC40-DDHNL-27055-15	40	110	27	55	-6°	-7°	0.38	
	15 PSC50-DDHNR-35060-15	50	110	35	60	-6°	-7°	0.66	
	15 PSC50-DDHNL-35060-15	50	110	35	60	-6°	-7°	0.66	
	15 PSC63-DDHNR-45065-15	63	110	45	65	-6°	-7°	1.15	
	15 PSC63-DDHNL-45065-15	63	110	45	65	-6°	-7°	1.15	
	15 PSC80-DDHNR-55080-15	80	110	55	80	-6°	-7°	2.36	
	15 PSC80-DDHNL-55080-15	80	110	55	80	-6°	-7°	2.36	
62.5°	15 PSC40-DDNNN-00055-15	40	-	0.5	55	-5°	-9°	0.38	DN.. 1506..
	15 PSC50-DDNNN-00060-15	50	-	0.5	60	-5°	-9°	0.62	
	15 PSC63-DDNNN-00065-15	63	-	0.5	65	-5°	-9°	1.06	
	15 PSC80-DDNNN-00080-15	80	-	0.5	80	-5°	-9°	2.1	

Main spare parts

PSC size	Insert	Shim screw	Shim	Key	Complete clamp set
PSC32-PSC63	11	ILD3072	322.267.01	242.090.40	412.028.011
PSC40-PSC80	15	ILD4085	322.266.02	248.150.10	412.028.021

• The insert need to be ordered separately. Other accessories are included in the order.
• The spare parts can be ordered separately. Please inquire on demand.

TOOLING ALSO ARTS

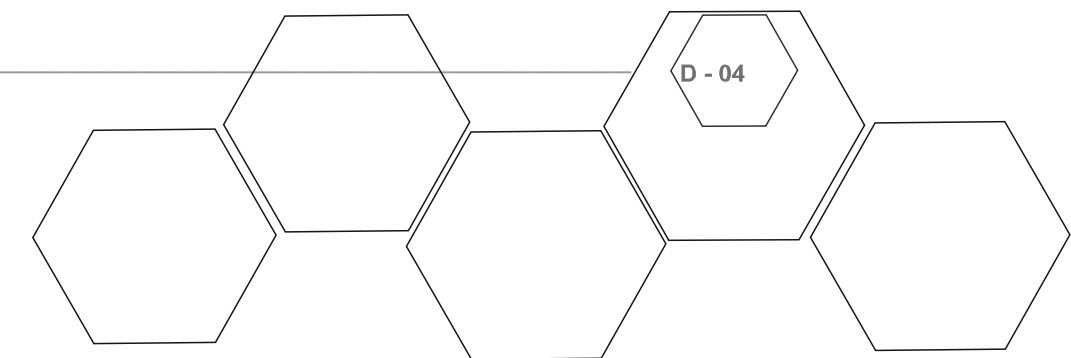

DSKNR/L-Kr 75° DSDNN-Kr 45° DSSNR/L-Kr 45°

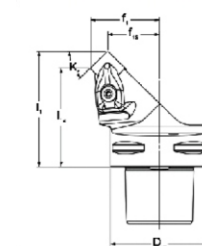
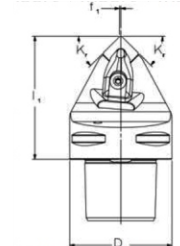
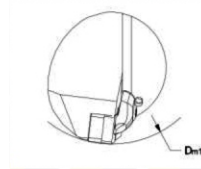

● SNMM SNMG SNMA SNGA

● SNMM SNMG SNMA SNGA
● The insert is for illustration only

Technical parameters

Unit: mm

(Kr)-Application	Ordering code	Dm	Dm1	f1	l1	f1s	l1s	γ	λ	m (kg)	ISO insert	
75°	PSC32-DSKNR-22040-12	32	60	22	40	-	-	-6°	-6°	0.2	SN.. 1204..	
	PSC32-DSKNL-22040-12	32	60	22	40	-	-	-6°	-6°	0.2		
	PSC40-DSKNR-27050-12	40	110	27	50	-	-	-6°	-6°	0.35		
	PSC40-DSKNL-27050-12	40	110	27	50	-	-	-6°	-6°	0.35		
	PSC50-DSKNR-35060-12	50	110	35	60	-	-	-6°	-6°	0.75		
	PSC50-DSKNL-35060-12	50	110	35	60	-	-	-6°	-6°	0.75		
	PSC63-DSKNR-45065-12	63	110	45	65	-	-	-6°	-6°	1.24		
	PSC63-DSKNL-45065-12	63	110	45	65	-	-	-6°	-6°	1.24		
	PSC50-DSKNR-35060-19	50	125	35	60	-	-	-6°	-6°	0.76		SN.. 1906..
	PSC50-DSKNL-35060-19	50	125	35	60	-	-	-6°	-6°	0.76		
	PSC63-DSKNR-45065-19	63	125	45	65	-	-	-6°	-6°	1.27		
	PSC63-DSKNL-45065-19	63	125	45	65	-	-	-6°	-6°	1.27		
PSC80-DSKNR-55080-19	80	125	55	80	-	-	-6°	-6°	2.54			
PSC80-DSKNL-55080-19	80	125	55	80	-	-	-6°	-6°	2.54			

D - 05

TOOLING ALSO ARTS

DSKNR/L-Kr 75° DSDNN-Kr 45° DSSNR/L-Kr 45°

Technical parameters

Unit: mm

(Kr)-Application	Ordering code	Dm	Dm1	f1	l1	f1s	l1s	γ	λ	m (kg)	ISO insert
45°	PSC32-DSDNN-00048-12	32	-	0.3	48	-	-	-6°	-6°	0.19	SN.. 1204..
	PSC40-DSDNN-00050-12	40	-	0.3	50	-	-	-6°	-6°	0.32	
	PSC50-DSDNN-00060-12	50	-	0.3	60	-	-	-6°	-6°	0.61	
	PSC63-DSDNN-00065-12	63	-	0.3	65	-	-	-6°	-6°	1.07	
45°	PSC32-DSSNR-22040-12	32	60	22	40	13.7	48.3	-8°	0°	0.19	SN.. 1204..
	PSC32-DSSNL-22040-12	32	60	22	40	13.7	48.3	-8°	0°	0.19	
	PSC40-DSSNR-27042-12	40	110	27	42	18.7	50.3	-8°	0°	0.31	
	PSC40-DSSNL-27042-12	40	110	27	42	18.7	50.3	-8°	0°	0.31	
	PSC50-DSSNR-35052-12	50	110	35	52	26.7	60.3	-8°	0°	0.6	
	PSC50-DSSNL-35052-12	50	110	35	52	26.7	60.3	-8°	0°	0.6	
	PSC63-DSSNR-45056-12	63	110	45	56	36.7	64.3	-8°	0°	0.99	
	PSC63-DSSNL-45056-12	63	110	45	56	36.7	64.3	-8°	0°	0.99	

Main spare parts

PSC size	Insert	Shim screw	Shim	Key	Complete clamp set
PSC32	12	ILD4085	322.426.02	248.150.10	412.028.021
PSC40-PSC63	12	ILD4085	322.425.01	248.150.10	412.028.021
PSC50-PSC80	19	ILD5011	322.425.04	248.200.10	412.028.041

● The insert need to be ordered separately. Other accessories are included in the order.
● The spare parts can be ordered separately. Please inquire on demand.

TOOLING ALSO ARTS

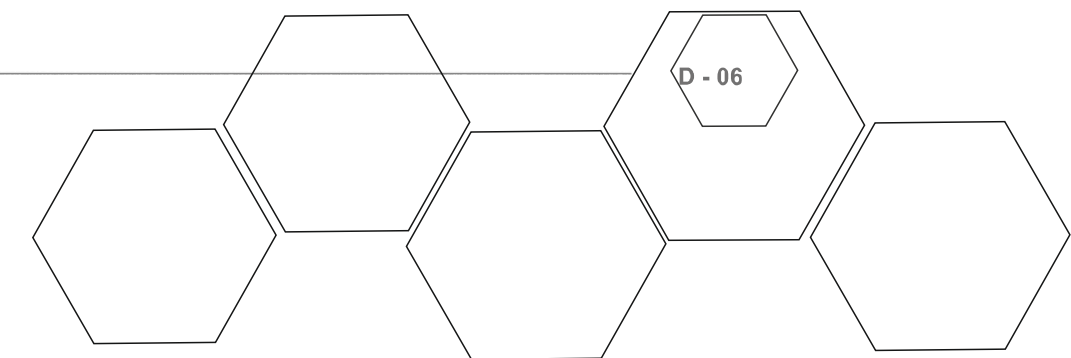

DWLNR/L-Kr 95°

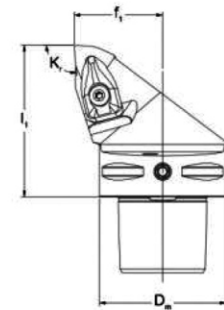
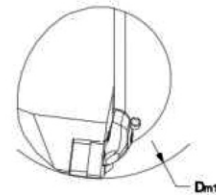
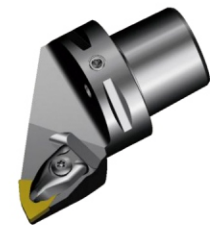

- WNMM WNMG WNGA WNMA

- WNMM WNMG WNGA WNMA
- The insert is for illustration only

Technical parameters

Unit: mm

(Kr)-Application		Ordering code	Dm	Dm1	f1	l1	γ	λ	m (kg)	ISO insert
95°		PSC32-DWLNR-22040-06	32	60	22	40	-6°	-6°	0.18	WN.. 0604..
		PSC32-DWLNL-22040-06	32	60	22	40	-6°	-6°	0.18	
		PSC40-DWLNR-27050-06	40	60	27	50	-6°	-6°	0.35	
		PSC40-DWLNL-27050-06	40	60	27	50	-6°	-6°	0.35	
		PSC50-DWLNR-35060-06	50	65	35	60	-6°	-6°	0.67	
		PSC50-DWLNL-35060-06	50	65	35	60	-6°	-6°	0.67	
		PSC63-DWLNR-45065-06	63	81	45	65	-6°	-6°	1.21	
		PSC63-DWLNL-45065-06	63	81	45	65	-6°	-6°	1.21	

DWLNR/L-Kr 95°

Technical parameters

Unit: mm

(Kr)-Application		Ordering code	Dm	Dm1	f1	l1	γ	λ	m (kg)	ISO insert
95°		PSC40-DWLNR-27050-08	40	110	27	50	-6°	-6°	0.35	WN.. 0804..
		PSC40-DWLNL-27050-08	40	110	27	50	-6°	-6°	0.35	
		PSC50-DWLNR-35060-08	50	110	35	60	-6°	-6°	0.67	
		PSC50-DWLNL-35060-08	50	110	35	60	-6°	-6°	0.67	
		PSC63-DWLNR-45065-08	63	110	45	65	-6°	-6°	1.22	
		PSC63-DWLNL-45065-08	63	110	45	65	-6°	-6°	1.22	
		PSC80-DWLNR-55080-08	80	110	55	80	-6°	-6°	2.44	
		PSC80-DWLNL-55080-08	80	110	55	80	-6°	-6°	2.44	

Main spare parts

PSC size	Insert	Shim screw	Shim	Key	Complete clamp set
PSC32-PSC63	06	ILD3072	322.328.01	242.090.40	412.028.011
PSC40-PSC80	08	ILD4085	322.331.12	248.150.10	412.028.021

- The insert need to be ordered separately. Other accessories are included in the order.
- The spare parts can be ordered separately. Please inquire on demand.

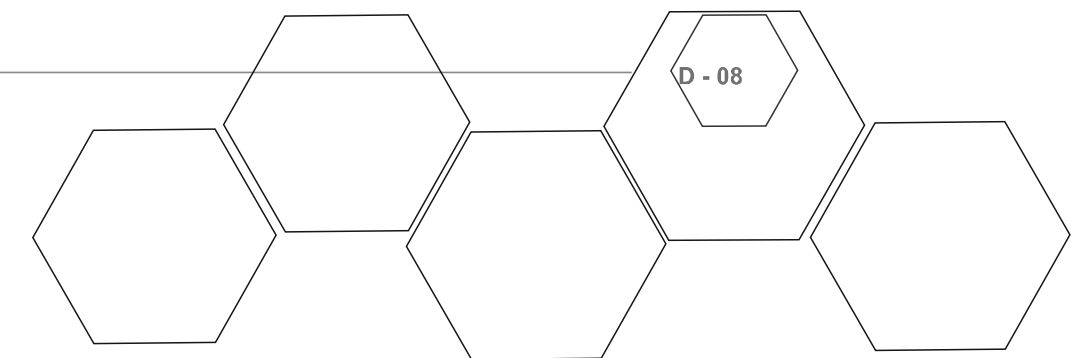

DVJNR/L-Kr 93° DVVNN/L-Kr 72.5°

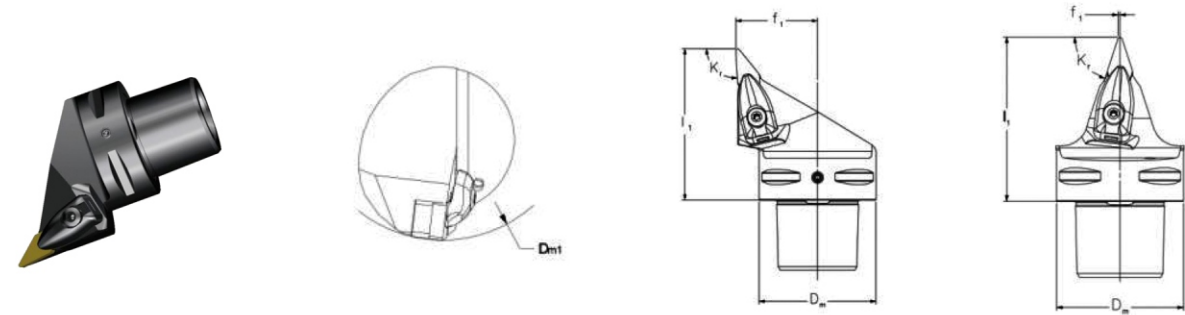

● VNMG VNGP

● VNMG VNGP
● The insert is for illustration only

Technical parameters

Unit: mm

(Kr)-Application		Ordering code	Dm	Dm1	f1	l1	γ	λ	m (kg)	ISO insert
93°		16 PSC40-DVJNR-27062-16	40	60	27	62	4°	-13°	0.4	VN.. 1604..
		16 PSC40-DVJNL-27062-16	40	60	27	62	4°	-13°	0.4	
		16 PSC50-DVJNR-35065-16	50	65	35	65	4°	-13°	0.65	
		16 PSC50-DVJNL-35065-16	50	65	35	65	4°	-13°	0.65	
		16 PSC63-DVJNR-45065-16	63	81	45	65	4°	-13°	1.01	
		16 PSC63-DVJNL-45065-16	63	81	45	65	4°	-13°	1.01	
		16 PSC80-DVJNR-55080-16	80	100	55	80	4°	-13°	2.1	
		16 PSC80-DVJNL-55080-16	80	100	55	80	4°	-13°	2.1	
72.5°		16 PSC40-DVNN-00062-16	40	-	0.6	62	4°	-13°	0.41	VN.. 1604..
		16 PSC50-DVNN-00065-16	50	-	0.6	65	4°	-13°	0.63	
		16 PSC63-DVNN-00065-16	63	-	0.6	65	4°	-13°	1.03	
		16 PSC80-DVNN-00080-16	80	-	0.6	80	4°	-13°	2	

Main spare parts

PSC size	Insert	Shim screw	Shim	Key	Complete clamp set
PSC40-PSC80	16	ILD3581	322.269.01	248.150.10	412.028.61

● The insert need to be ordered separately. Other accessories are included in the order.
● The spare parts can be ordered separately. Please inquire on demand.

D - 09

TOOLING ALSO ARTS

DTJNR/L-Kr 93°

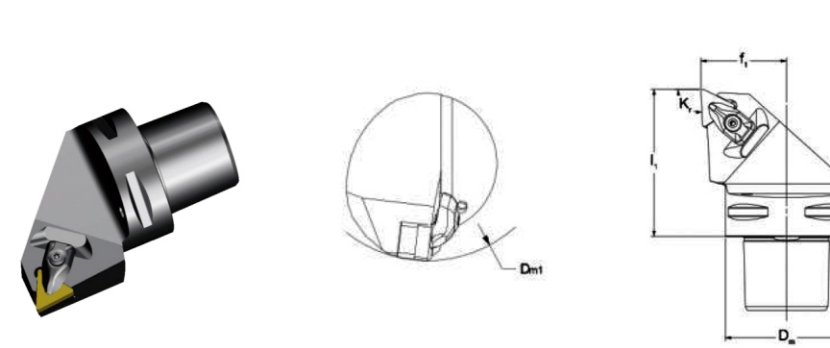

● TNMM TNMX TNMG TNMA TNGA

● TNMM TNMX TNMG TNMA TNGA
● The insert is for illustration only

Technical parameters

Unit: mm

(Kr)-Application		Ordering code	Dm	Dm1	f1	l1	γ	λ	m (kg)	ISO insert
93°		16 PSC32-DTJNR-22040-16	32	60	22	40	-6°	-6°	0.2	TN.. 1604..
		16 PSC32-DTJNL-22040-16	32	60	22	40	-6°	-6°	0.2	
		16 PSC40-DTJNR-27050-16	40	110	27	50	-6°	-6°	0.43	
		16 PSC40-DTJNL-27050-16	40	110	27	50	-6°	-6°	0.43	
		16 PSC50-DTJNR-35060-16	50	110	35	60	-6°	-6°	0.78	
		16 PSC50-DTJNL-35060-16	50	110	35	60	-6°	-6°	0.78	
		16 PSC63-DTJNR-45065-16	63	110	45	65	-6°	-6°	1.34	
		16 PSC63-DTJNL-45065-16	63	110	45	65	-6°	-6°	1.34	

Main spare parts

PSC size	Insert	Shim screw	Shim	Key	Complete clamp set
PSC32	16	ILD3072	322.316.01	242.090.40	412.028.11
PSC40-PSC80	16	ILD3072	322.315.02	242.090.40	412.028.11

● The insert need to be ordered separately. Other accessories are included in the order.
● The spare parts can be ordered separately. Please inquire on demand.

TOOLING ALSO ARTS

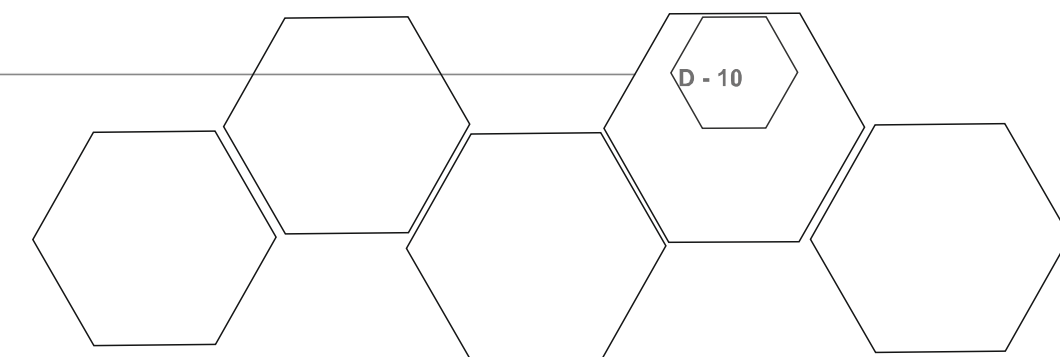

PCLNR/L-Kr 95°

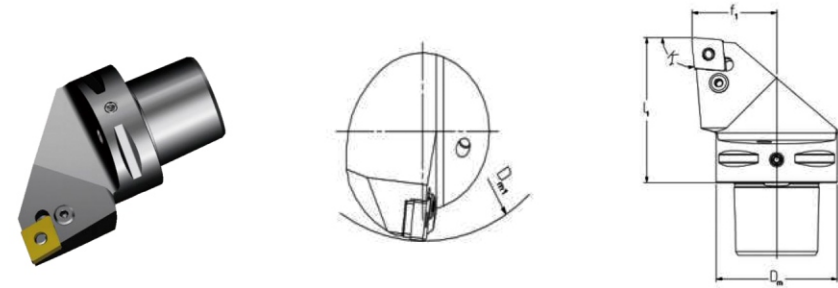

● CNMM CNMG CNMA CNGA

● CNMM CNMG CNMA CNGA
● The insert is for illustration only

Technical parameters

Unit: mm

(Kr)-Application		Ordering code	Dm	f1	l1	γ	λ	m (kg)	ISO insert	
95°		12	PSC40-PCLNR-27050-12	40	27	50	-6°	-6°	0.36	CN.. 1204..
		12	PSC40-PCLNL-27050-12	40	27	50	-6°	-6°	0.36	
		12	PSC50-PCLNR-35060-12	50	35	60	-6°	-6°	0.68	
		12	PSC50-PCLNL-35060-12	50	35	60	-6°	-6°	0.68	
		12	PSC63-PCLNR-45065-12	63	45	65	-6°	-6°	1.19	
		12	PSC63-PCLNL-45065-12	63	45	65	-6°	-6°	1.19	
		12	PSC80-PCLNR-55080-12	80	55	80	-6°	-6°	2.39	
		12	PSC80-PCLNL-55080-12	80	55	80	-6°	-6°	2.39	
		CN.. 1606..	16	PSC40-PCLNR-27050-16	40	27	50	-6°	-6°	0.35
			16	PSC40-PCLNL-27050-16	40	27	50	-6°	-6°	0.35
			16	PSC50-PCLNR-35060-16	50	35	60	-6°	-6°	0.68
			16	PSC50-PCLNL-35060-16	50	35	60	-6°	-6°	0.68
			16	PSC63-PCLNR-45065-16	63	45	65	-6°	-6°	1.19
			16	PSC63-PCLNL-45065-16	63	45	65	-6°	-6°	1.19
16	PSC80-PCLNL-55080-16	80	55	80	-6°	-6°	2.39			
16	PSC80-PCLNL-55080-16	80	55	80	-6°	-6°	2.39			

PCLNR/L-Kr 95°

Technical parameters

Unit: mm

(Kr)-Application		Ordering code	Dm	f1	l1	γ	λ	m (kg)	ISO insert	
95°		19	PSC50-PCLNR-35060-19	50	35	60	-6°	-6°	0.68	CN.. 1906..
		19	PSC50-PCLNL-35060-19	50	35	60	-6°	-6°	0.68	
		19	PSC63-PCLNR-45065-19	63	45	65	-6°	-6°	1.19	
		19	PSC63-PCLNL-45065-19	63	45	65	-6°	-6°	1.19	
		19	PSC80-PCLNL-55080-19	80	55	80	-6°	-6°	2.39	
		19	PSC80-PCLNL-55080-19	80	55	80	-6°	-6°	2.39	

Main spare parts

PSC size	Insert	Shim screw	Shim	Key	Lever
PSC40-PSC63	12	414.438.21	322.318.50	241.030.63	413.438.41
PSC40-PSC80	16	414.838.31	322.318.52	241.030.63	413.838.40
PSC50-PSC80	19	414.438.22	322.318.51	241.030.63	413.438.42

- The insert need to be ordered separately. Other accessories are included in the order.
- The spare parts can be ordered separately. Please inquire on demand.

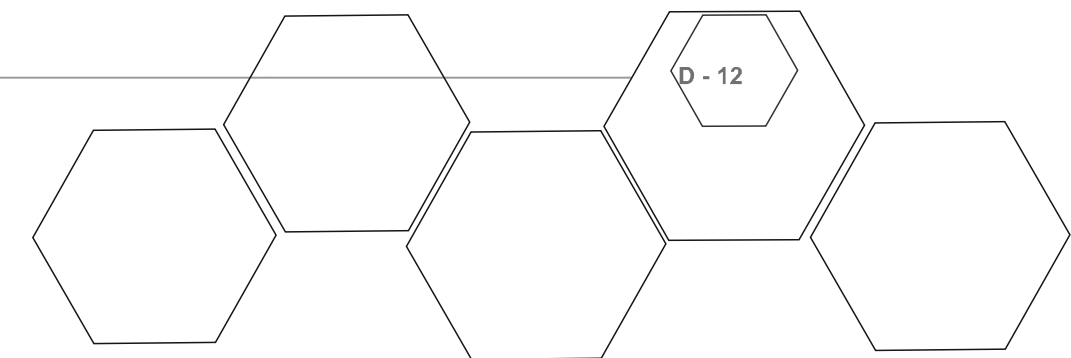

PDJNR/L-Kr 93°

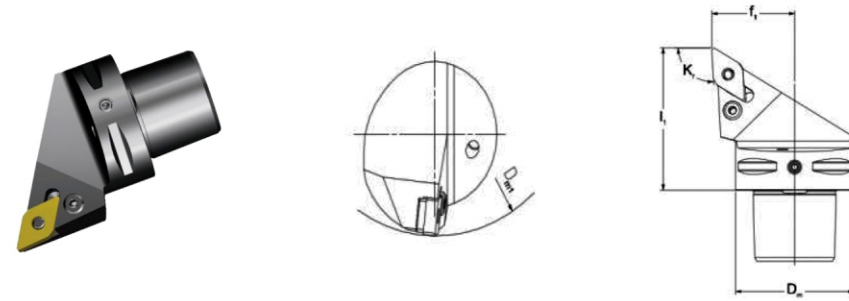

- DNMM DNMX DNMG DNMA DNMA

- DNMM DNMX DNMG DNMA DNMA
- The insert is for illustration only

Technical parameters

Unit: mm

(Kr)-Application		Ordering code	Dm	f1	l1	γ	λ	m (kg)	ISO insert
	15	PSC40-PDJNR-27055-15	40	27	55	-6°	-7°	0.36	DN.. 1506..
	15	PSC40-PDJNL-27055-15	40	27	55	-6°	-7°	0.36	
	15	PSC50-PDJNR-35060-15	50	35	60	-6°	-7°	0.62	
	15	PSC50-PDJNL-35060-15	50	35	60	-6°	-7°	0.62	
	15	PSC63-PDJNR-45065-15	63	45	65	-6°	-7°	1.05	
	15	PSC63-PDJNL-45065-15	63	45	65	-6°	-7°	1.05	

Main spare parts

PSC size	Insert	Shim screw	Shim	Key	Lever
PSC40-PSC63	15	414.438.30	322.358.51	241.030.63	413.438.47

- The insert need to be ordered separately. Other accessories are included in the order.
- The spare parts can be ordered separately. Please inquire on demand.

PSKNR/L-Kr 75°

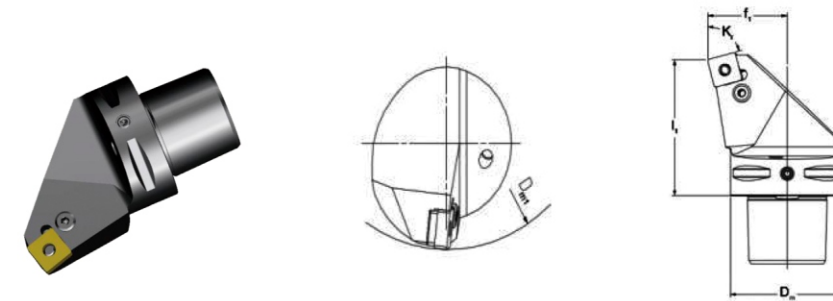

- SNMM SNMG SNMA SNGA

- SNMM SNMG SNMA SNGA
- The insert is for illustration only

Technical parameters

Unit: mm

(Kr)-Application		Ordering code	Dm	f1	l1	γ	λ	m (kg)	ISO insert
	12	PSC40-PSKNR-27050-12	40	27	50	-6°	-6°	0.34	SN.. 1204..
	12	PSC40-PSKNL-27050-12	40	27	50	-6°	-6°	0.34	
	12	PSC50-PSKNR-35060-12	50	35	60	-6°	-6°	0.72	
	12	PSC50-PSKNL-35060-12	50	35	60	-6°	-6°	0.72	
	12	PSC63-PSKNR-45065-12	63	45	65	-6°	-6°	1.15	
	12	PSC63-PSKNL-45065-12	63	45	65	-6°	-6°	1.15	

Main spare parts

PSC size	Insert	Shim screw	Shim	Key	Lever
PSC40-PSC63	12	414.438.21	322.438.51	241.030.63	413.438.41

- The insert need to be ordered separately. Other accessories are included in the order.
- The spare parts can be ordered separately. Please inquire on demand.

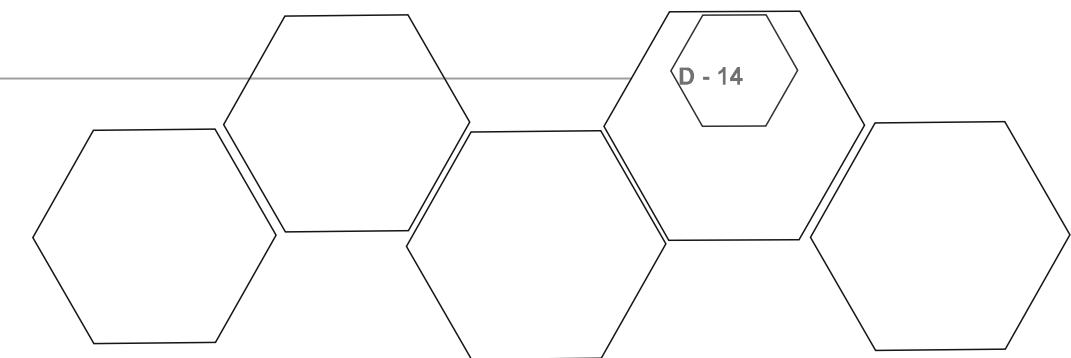

SCLCR/L-Kr 95°

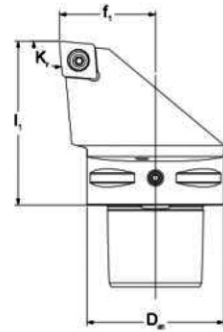

- CCMT CCGT CCGX CCET CCMW

- CCMT CCGT CCGX CCET CCMW
- The insert is for illustration only

Technical parameters

Unit: mm

(Kr)-Application		Ordering code	Dm	f1	l1	γ	λ	m (kg)	ISO insert
95°		PSC32-SCLCR-22040-12	32	22	40	0°	0°	0.2	CC..1204..
		PSC32-SCLCL-22040-12	32	22	40	0°	0°	0.2	
		PSC40-SCLCR-27050-12	40	27	50	0°	0°	0.44	
		PSC40-SCLCL-27050-12	40	27	50	0°	0°	0.44	
		PSC50-SCLCR-35060-12	50	35	60	0°	0°	0.77	
		PSC50-SCLCL-35060-12	50	35	60	0°	0°	0.77	
		PSC63-SCLCR-45065-12	63	45	65	0°	0°	1.34	
		PSC63-SCLCL-45065-12	63	45	65	0°	0°	1.34	

Main spare parts

PSC size	Insert	Shim screw	Shim	Key	Insert screw
PSC32-PSC63	12	512.090.03	322.232.02	248.150.10 & 241.040.70	ILD4014

- The insert need to be ordered separately. Other accessories are included in the order.
- The spare parts can be ordered separately. Please inquire on demand.

D - 15

TOOLING ALSO ARTS

SDJCR/L-Kr 93°

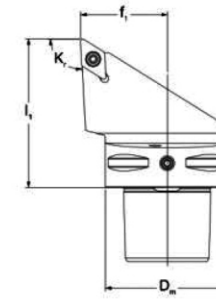

- DCMT DCMX DCGT DCGX DCET DCMW

- DCMT DCMX DCGT DCGX DCET DCMW
- The insert is for illustration only

Technical parameters

Unit: mm

(Kr)-Application		Ordering code	Dm	f1	l1	γ	λ	m (kg)	ISO insert
93°		PSC32-SDJCR-22040-11	32	22	40	0°	0°	0.16	DC..11T3..
		PSC32-SDJCL-22040-11	32	22	40	0°	0°	0.16	
		PSC40-SDJCR-27050-11	40	27	50	0°	0°	0.33	
		PSC40-SDJCL-27050-11	40	27	50	0°	0°	0.33	
		PSC50-SDJCR-35060-11	50	35	60	0°	0°	0.63	
		PSC50-SDJCL-35060-11	50	35	60	0°	0°	0.63	
		PSC63-SDJCR-45065-11	63	45	65	0°	0°	1.05	
		PSC63-SDJCL-45065-11	63	45	65	0°	0°	1.05	

Main spare parts

PSC size	Insert	Shim screw	Shim	Key	Insert screw
PSC32-PSC63	11	512.090.01	322.263.01	248.150.10 & 241.035.65	ILD3512

- The insert need to be ordered separately. Other accessories are included in the order.
- The spare parts can be ordered separately. Please inquire on demand.

TOOLING ALSO ARTS

D - 16

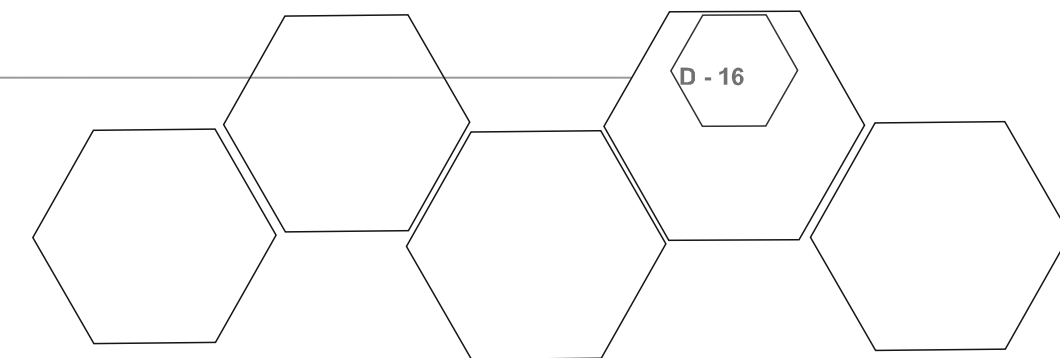

SVHBR/L-Kr 107.5° SVJBR/L-Kr 93°

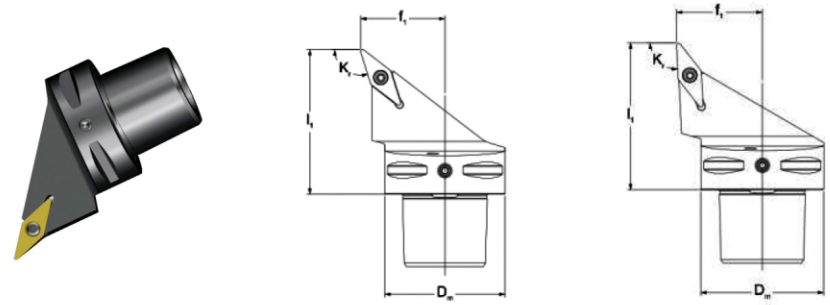

● VBMT VBGT VCGX VCEX VCGT VCET VBMW VCMW

● VBMT VBGT VCGX VCEX VCGT VCET VBMW VCMW
● The insert is for illustration only

Technical parameters

Unit: mm

(Kr)-Application	Ordering code	Dm	f1	l1	γ	λ	m (kg)	ISO insert
107.5°	PSC40-SVHBR-27050-16	40	27	50	0°	0°	0.38	VB..1604.. VC..1604..
	PSC40-SVHBL-27050-16	40	27	50	0°	0°	0.38	
	PSC50-SVHBR-35060-16	50	35	60	0°	0°	0.64	
	PSC50-SVHBL-35060-16	50	35	60	0°	0°	0.64	
	PSC63-SVHBR-45065-16	63	45	65	0°	0°	1.12	
	PSC63-SVHBL-45065-16	63	45	65	0°	0°	1.12	
93°	PSC40-SVJBR-27050-16	40	27	50	0°	0°	0.35	VB..1604.. VC..1604..
	PSC40-SVJBL-27050-16	40	27	50	0°	0°	0.35	
	PSC50-SVJBR-35060-16	50	35	60	0°	0°	0.7	
	PSC50-SVJBL-35060-16	50	35	60	0°	0°	0.7	
	PSC63-SVJBR-45065-16	63	45	65	0°	0°	1.11	
	PSC63-SVJBL-45065-16	63	45	65	0°	0°	1.11	

Main spare parts

PSC size	Insert	Shim screw	Shim	Key	Insert screw
PSC32-PSC63	16	512.090.01	322.270.01	248.150.10 & 241.035.65	ILD3512

● The insert need to be ordered separately. Other accessories are included in the order.
● The spare parts can be ordered separately. Please inquire on demand.

SRDCN SRSCR/L

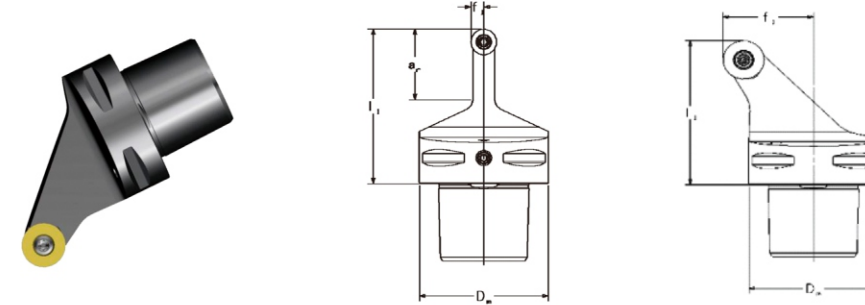

● RCMT RCGX-AL

● RCMT RCGX-AL
● The insert is for illustration only

Technical parameters

Unit: mm

(Kr)-Application	Ordering code	Dm	ar	f1	l1	γ	λ	m (kg)	ISO insert
	PSC32-SRDCN-00040-10A	32	20	5	40	0°	0°	0.13	RC.10T3M0
	PSC40-SRDCN-00050-10A	40	25	5	50	0°	0°	0.27	
	PSC50-SRDCN-00060-10A	50	25	5	60	0°	0°	0.51	
	PSC63-SRDCN-00065-10A	63	25	5	65	0°	0°	0.91	
	PSC50-SRSCR-35060-16	50	-	35	60	0°	0°	0.56	RC.1606M0
	PSC50-SRCL-35060-16	50	-	35	60	0°	0°	0.56	
	PSC63-SRSCR-45065-16	63	-	45	65	0°	0°	1.03	
	PSC63-SRCL-45065-16	63	-	45	65	0°	0°	1.03	

Main spare parts

PSC size	Insert	Shim screw	Shim	Key	Insert screw
PSC32-PSC63	10	512.090.01	322.110.01	248.150.10 & 251.035.65	ILD3510
PSC50-PSC63	16	512.090.06	322.110.03	248.200.10 & 241.050.80	ILD5017

● The insert need to be ordered separately. Other accessories are included in the order.
● The spare parts can be ordered separately. Please inquire on demand.

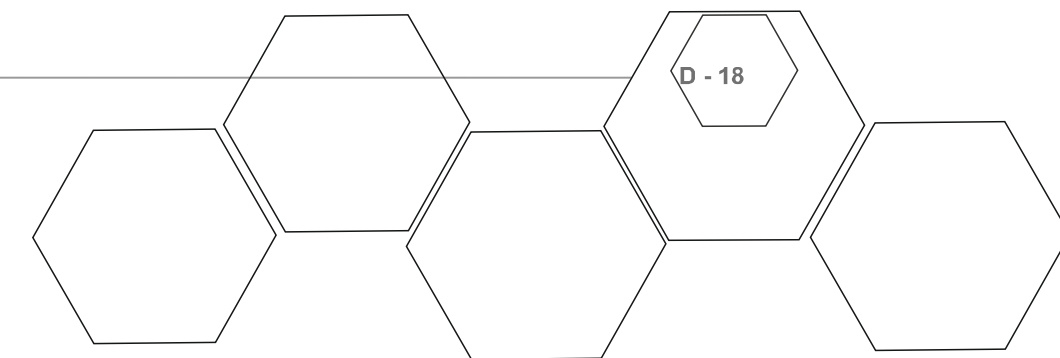

INTERNAL TURNING TOOL BODY



- For turning the internal of the workpiece;
- The maximum length of standard turning tool body can be 140mm;
- Out-machine tool adjustment, can be used in automatic mechanical equipment;
- Match the ISO standard insert on the market;
- Support non-standard customization.

D - 19

TOOLING ALSO ARTS

DCLNR/L-Kr 95°

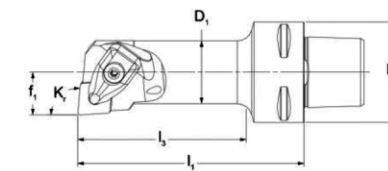
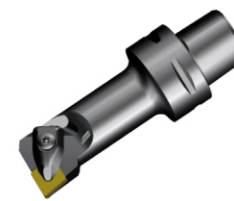

• CNMM CNMG CNMA CNGA

• CNMM CNMG CNMA CNGA
• The insert is for illustration only

Technical parameters

Unit: mm

(Kr)-Application		Ordering code	Dm	Dmin	D1	f1	l1	l3	γ	λ	m (kg)	ISO insert
	12	PSC40-DCLNR-17090-12	40	32	25	17	90	69	-6°	-12°	0.47	CN.. 1204..
	12	PSC40-DCLNL-17090-12	40	32	25	17	90	69	-6°	-12°	0.47	
	12	PSC50-DCLNR-17090-12	50	32	25	17	90	67	-6°	-12°	0.65	
	12	PSC50-DCLNL-17090-12	50	32	25	17	90	67	-6°	-12°	0.65	
	12	PSC63-DCLNR-17100-12	63	32	25	17	100	73	-6°	-12°	1.04	
	12	PSC63-DCLNL-17100-12	63	32	25	17	100	73	-6°	-12°	1.04	

Main spare parts

PSC size	Insert	Shim screw	Shim	Key	Complete clamp set
PSC40-PSC63	12	ILD4085	322.236.03	248.150.10	412.028.021

- The insert need to be ordered seperately. Other accessories are included in the order.
- The spare parts can be ordered separately. Please inquire on demand.

TOOLING ALSO ARTS

D - 20

DDUNR/L-Kr 93°

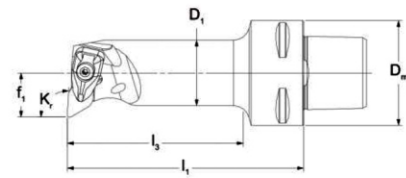
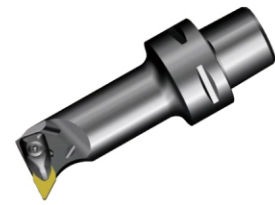

- DNMM DNMX DNMG DNMA DNMA

- DNMM DNMX DNMG DNMA DNMA
- The insert is for illustration only

Technical parameters

Unit: mm

(Kr)-Application		Ordering code	Dm	Dmin	D1	f1	l1	l3	γ	λ	m (kg)	ISO insert
93°		11 PSC40-DDUNR-17090-11	40	32	25	17	90	68	-6°	-12°	0.47	DN.. 1104..
		11 PSC40-DDUNL-17090-11	40	32	25	17	90	68	-6°	-12°	0.47	
		11 PSC50-DDUNR-17090-11	50	32	25	17	90	66	-6°	-12°	0.65	DN.. 1104..
		11 PSC50-DDUNL-17090-11	50	32	25	17	90	66	-6°	-12°	0.65	
		15 PSC40-DDUNR-27080-15	40	50	39.7	27	80	59	-6°	-11°	1.04	DN.. 1506..
		15 PSC40-DDUNL-27080-15	40	50	39.7	27	80	59	-6°	-11°	1.04	
		15 PSC50-DDUNR-27140-15	50	50	40	27	140	118	-6°	-11°	1.04	
		15 PSC50-DDUNL-27140-15	50	50	40	27	140	118	-6°	-11°	1.04	
		15 PSC63-DDUNR-27140-15	63	50	40	27	140	114	-6°	-11°	1.04	
		15 PSC63-DDUNL-27140-15	63	50	40	27	140	114	-6°	-11°	1.04	

Main spare parts

PSC size	Insert	Shim screw	刀墊 Shim	Key	Complete clamp set
PSC40-PSC50	11	ILD3072	322.267.01	242.090.40	412.028.011
PSC40-PSC63	15	ILD4085	322.266.02	248.150.10	412.028.021

- The insert need to be ordered separately. Other accessories are included in the order.
- The spare parts can be ordered separately. Please inquire on demand.

DWLNR/L-Kr 95°

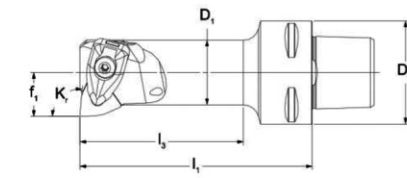

- WNMM WNMG WNGA WNMA

- WNMM WNMG WNGA WNMA
- The insert is for illustration only

Technical parameters

Unit: mm

(Kr)-Application		Ordering code	Dm	Dmin	D1	f1	l1	l3	γ	λ	m (kg)	ISO insert
95°		08 PSC40-DWLNR-17090-08	40	32	25	17	90	69	-0°	-6°	0.48	WN.. 0804..
		08 PSC40-DWLNL-17090-08	40	32	25	17	90	69	-0°	-6°	0.48	
		08 PSC50-DWLNR-17090-08	50	32	25	17	90	69	-0°	-6°	0.67	WN.. 0804..
		08 PSC50-DWLNL-17090-08	50	32	25	17	90	69	-0°	-6°	0.67	

Main spare parts

PSC size	Insert	Shim screw	Shim	Key	Complete clamp set
PSC40-PSC50	08	ILD4085	322.328.02	248.150.10	412.028.021

- The insert need to be ordered separately. Other accessories are included in the order.
- The spare parts can be ordered separately. Please inquire on demand.

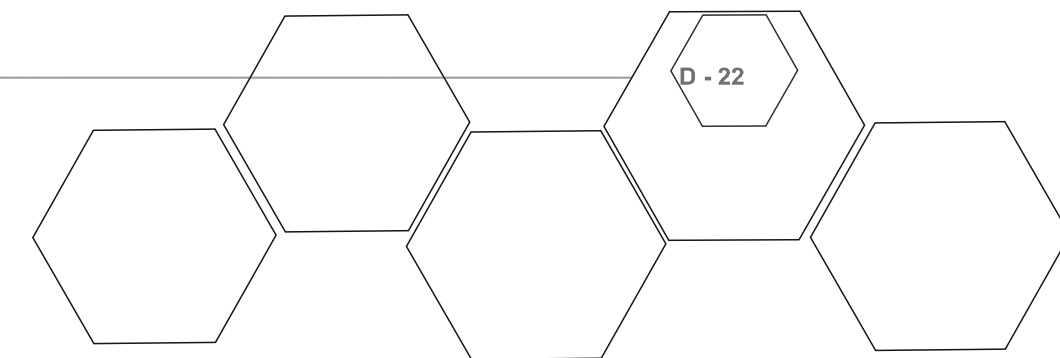

PCLNR/L-Kr 95°

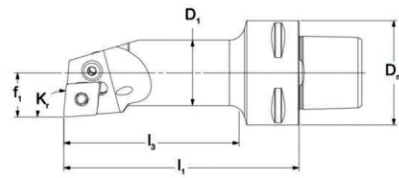

● CNMM CNMG CNMA CNGA

● CNMM CNMG CNMA CNGA
● The insert is for illustration only

Technical parameters

Unit: mm

(Kr)-Application	Ordering code	Dm	Dmin	D1	f1	l1	l3	γ	λ	m (kg)	ISO insert
95°	12 PSC32-PCLNR-17090-12	32	32	25	17	90	75	-6°	-11°	0.3	CN.. 1204..
	12 PSC32-PCLNL-17090-12	32	32	25	17	90	75	-6°	-11°	0.3	
	12 PSC32-PCLNR-22064-12	32	40	32	22	64	50	-6°	-11°	0.3	
	12 PSC32-PCLNL-22064-12	32	40	32	22	64	50	-6°	-11°	0.3	
	12 PSC32-PCLNR-22096-12	32	40	32	22	96	82	-6°	-11°	0.3	
	12 PSC32-PCLNL-22096-12	32	40	32	22	96	82	-6°	-11°	0.3	
	12 PSC40-PCLNR-17090-12	40	32	25	17	90	69	-6°	-11°	0.5	
	12 PSC40-PCLNL-17090-12	40	32	25	17	90	69	-6°	-11°	0.5	
	12 PSC40-PCLNR-22110-12	40	40	32	22	110	89	-6°	-11°	0.5	
	12 PSC40-PCLNL-22110-12	40	40	32	22	110	89	-6°	-11°	0.5	
	12 PSC40-PCLNR-27080-12	40	50	40	27	80	60	-6°	-10°	0.5	
	12 PSC40-PCLNL-27080-12	40	50	40	27	80	60	-6°	-10°	0.5	
	12 PSC40-PCLNR-27120-12	40	50	40	27	120	100	-6°	-11°	0.5	
	12 PSC40-PCLNL-27120-12	40	50	40	27	120	100	-6°	-11°	0.5	

PCLNR/L-Kr 95°

Technical parameters

Unit: mm

(Kr)-Application	Ordering code	Dm	Dmin	D1	f1	l1	l3	γ	λ	m (kg)	ISO insert
95°	12 PSC50-PCLNR-17090-12	50	32	25	17	90	67	-6°	-11°	0.65	CN.. 1204..
	12 PSC50-PCLNL-17090-12	50	32	25	17	90	67	-6°	-11°	0.65	
	12 PSC50-PCLNR-22110-12	50	40	32	22	110	88	-6°	-11°	0.66	
	12 PSC50-PCLNL-22110-12	50	40	32	22	110	88	-6°	-11°	0.66	
	12 PSC50-PCLNR-27140-12	50	50	40	27	140	119	-6°	-10°	0.67	
	12 PSC50-PCLNL-27140-12	50	50	40	27	140	119	-6°	-10°	0.67	
	12 PSC50-PCLNR-35100-12	50	63	50	35	100	81	-6°	-7°	0.68	
	12 PSC50-PCLNL-35100-12	50	63	50	35	100	81	-6°	-7°	0.68	
	12 PSC63-PCLNR-17100-12	63	32	25	17	100	74	-6°	-11°	1	
	12 PSC63-PCLNL-17100-12	63	32	25	17	100	74	-6°	-11°	1	
	12 PSC63-PCLNR-22110-12	63	40	32	22	110	84	-6°	-11°	1.2	
	12 PSC63-PCLNL-22110-12	63	40	32	22	110	84	-6°	-11°	1.2	

Main spare parts

PSC size	Insert	Screw	Shim	Key	Lever
PSC32-PSC63(D25)	12	414.838.32	-	241.025.56	413.838.41-1
PSC32-PSC63(D32-D50)	12	414.438.21	322.318.50	241.030.63	413.438.41

● The insert need to be ordered separately. Other accessories are included in the order.
● The spare parts can be ordered separately. Please inquire on demand.

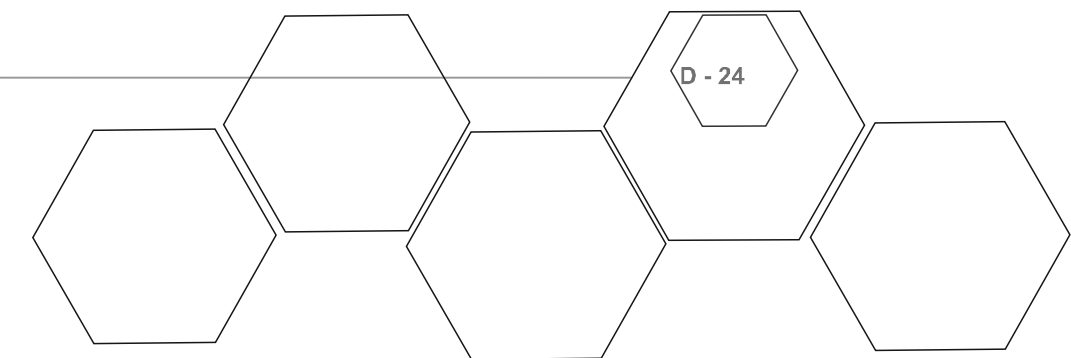

PSKNR/L-Kr 75°

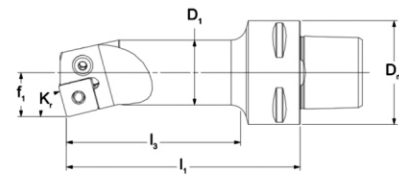

● SNMM SNMG SNMA SNGA

● SNMM SNMG SNMA SNGA
● The insert is for illustration only

Technical parameters

Unit: mm

(Kr)-Application	Ordering code	Dm	Dmin	D1	f1	l1	l3	γ	λ	m (kg)	ISO insert
75°	12 PSC40-PSKNR-17090-12	40	32	25	17	90	69	-6°	-11°	0.45	SN.. 1204..
	12 PSC50-PSKNR-17090-12	50	32	25	17	90	67	-6°	-11°	0.51	
	12 PSC50-PSKNR-22110-12	50	40	32	22	110	88	-6°	-10°	0.7	
	12 PSC50-PSKNR-27140-12	50	50	40	27	140	119	-6°	-10°	1.4	
	12 PSC63-PSKNR-22110-12	63	40	32	22	110	84	-6°	-10°	1.3	

Main spare parts

PSC size	Insert	Screw	Shim	Key	Lever
PSC40-PSC50(D25)	12	414.838.32	-	241.025.56	413.838.41-1
PSC50-PSC63(D32-D40)	12	414.438.21	322.438.51	241.030.63	413.438.41

● The insert need to be ordered separately. Other accessories are included in the order.
● The spare parts can be ordered separately. Please inquire on demand.

D - 25

TOOLING ALSO ARTS

SCLCR/L-Kr 95°

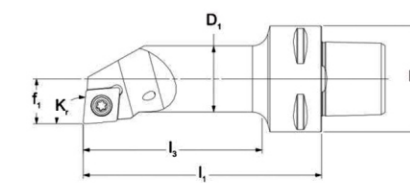
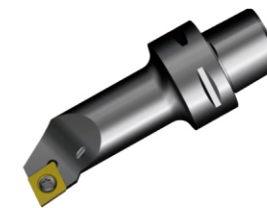

● CCMT CCGT CCGX CCET CCMW

● CCMT CCGT CCGX CCET CCMW
● The insert is for illustration only

Technical parameters

Unit: mm

(Kr)-Application	Ordering code	Dm	Dmin	D1	f1	l1	l3	γ	λ	m (kg)	ISO insert
95°	12 PSC32-SCLCR-17090-12	32	32	25	17	90	75	0°	-6°	0.32	CC..1204..
	12 PSC32-SCLCL-17090-12	32	32	25	17	90	75	0°	-6°	0.32	
	12 PSC32-SCLCR-22064-12	32	40	31.7	22	64	50	0°	-10°	0.31	
	12 PSC32-SCLCL-22064-12	32	40	31.7	22	64	50	0°	-10°	0.31	
	12 PSC32-SCLCR-22090-12	32	40	31.7	22	90	82	0°	-10°	0.5	
	12 PSC32-SCLCL-22090-12	32	40	31.7	22	90	82	0°	-10°	0.5	
	12 PSC40-SCLCR-17090-12	40	32	25	17	90	69	0°	-6°	0.45	
	12 PSC40-SCLCL-17090-12	40	32	25	17	90	69	0°	-6°	0.45	
	12 PSC40-SCLCR-22110-12	40	40	32	22	110	89	0°	-10°	0.68	
	12 PSC40-SCLCL-22110-12	40	40	32	22	110	89	0°	-10°	0.68	
	12 PSC40-SCLCR-27080-12	40	50	39.7	27	80	60	0°	-8°	0.63	
	12 PSC40-SCLCL-27080-12	40	50	39.7	27	80	60	0°	-8°	0.63	

TOOLING ALSO ARTS

D - 26

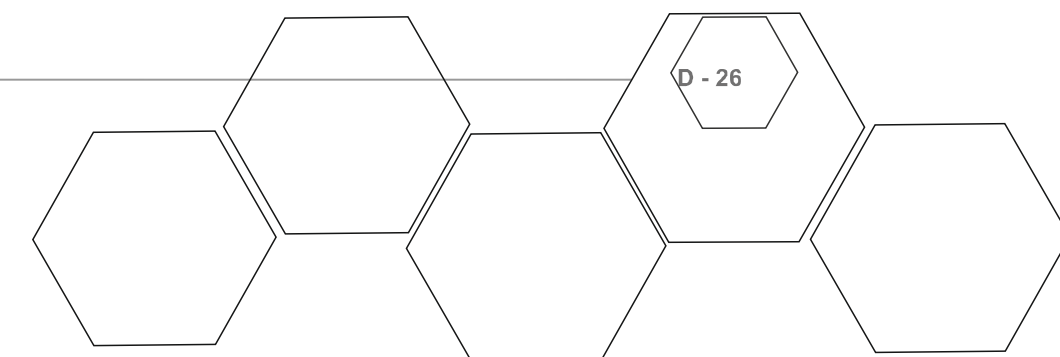

SCLCR/L-Kr 95°

Technical parameters

Unit: mm

(Kr)-Application	Ordering code	Dm	Dmin	D1	f1	l1	l3	γ	λ	m (kg)	ISO insert
95°	12 PSC50-SCLCR-17090-12	50	32	25	17	90	67	0°	-6°	0.63	CC..1204..
	12 PSC50-SCLCL-17090-12	50	32	25	17	90	67	0°	-6°	0.63	
	12 PSC50-SCLCR-22110-12	50	40	32	22	110	88	0°	-10°	0.87	
	12 PSC50-SCLCL-22110-12	50	40	32	22	110	88	0°	-10°	0.87	
	12 PSC50-SCLCR-27140-12	50	50	40	27	140	119	0°	-8°	1.35	
	12 PSC50-SCLCL-27140-12	50	50	40	27	140	119	0°	-8°	1.35	
	12 PSC50-SCLCR-35100-12	50	63	49.7	35	100	80	0°	-5°	1.27	
	12 PSC50-SCLCL-35100-12	50	63	49.7	35	100	80	0°	-5°	1.27	

Main spare parts

PSC size	Insert	Shim screw	Shim	Key	Insert screw
PSC32-PSC50(D25)	12	-	-	248.150.10	ILD4011-A
PSC32-PSC50(D32-D40)	12	512.090.03	322.232.02	248.150.10 & 241.040.70	ILD4014

- The insert need to be ordered separately. Other accessories are included in the order.
- The spare parts can be ordered separately. Please inquire on demand.

SDUCR/L-Kr 93°

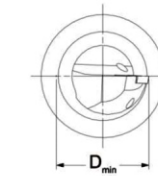
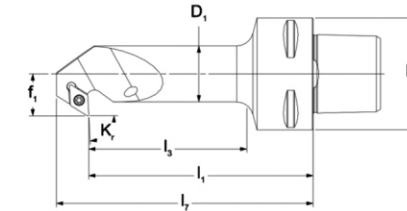
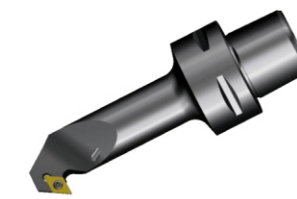

- DCMT DCMX DCGT DCGX DCET DCMW

- DCMT DCMX DCGT DCGX DCET DCMW
- The insert is for illustration only

Technical parameters

Unit: mm

(Kr)-Application	Ordering code	Dm	Dmin	D1	f1	l1	l3	l7	γ	λ	m (kg)	ISO insert
93°	07 PSC32-SDUCR-13070-07X	32	22	16	13	70	54	80.7	0°	-6°	0.19	DC.. 0702..
	07 PSC32-SDUCL-13070-07X	32	22	16	13	70	54	80.7	0°	-6°	0.19	
	07 PSC32-SDUCR-15080-07X	32	27	20	15	80	64	91.5	0°	-3°	0.26	
	07 PSC32-SDUCL-15080-07X	32	27	20	15	80	64	91.5	0°	-3°	0.26	
	07 PSC40-SDUCR-13070-07X	40	22	16	13	70	48	80.7	0°	-6°	0.32	
	07 PSC40-SDUCL-13070-07X	40	22	16	13	70	48	80.7	0°	-6°	0.32	
	07 PSC40-SDUCR-15080-07X	40	27	20	15	80	58	91.5	0°	-3°	0.39	
	07 PSC40-SDUCL-15080-07X	40	27	20	15	80	58	91.5	0°	-3°	0.39	
	07 PSC40-SDUCR-18090-07X	40	32	25	18	90	69	101.5	0°	-3°	0.49	
	07 PSC40-SDUCL-18090-07X	40	32	25	18	90	69	101.5	0°	-3°	0.49	
	07 PSC50-SDUCR-15080-07X	50	27	20	15	80	58	91.5	0°	-3°	0.58	
	07 PSC50-SDUCL-15080-07X	50	27	20	15	80	58	91.5	0°	-3°	0.58	
	07 PSC50-SDUCR-18090-07X	50	32	25	18	90	68	101.5	0°	-3°	0.67	
	07 PSC50-SDUCL-18090-07X	50	32	25	18	90	68	101.5	0°	-3°	0.67	

Main spare parts

PSC size	Insert	Shim screw	Shim	Key	Insert screw
PSC32-PSC50	7	-	-	242.070.35	ILD2565

- The insert need to be ordered separately. Other accessories are included in the order.
- The spare parts can be ordered separately. Please inquire on demand.

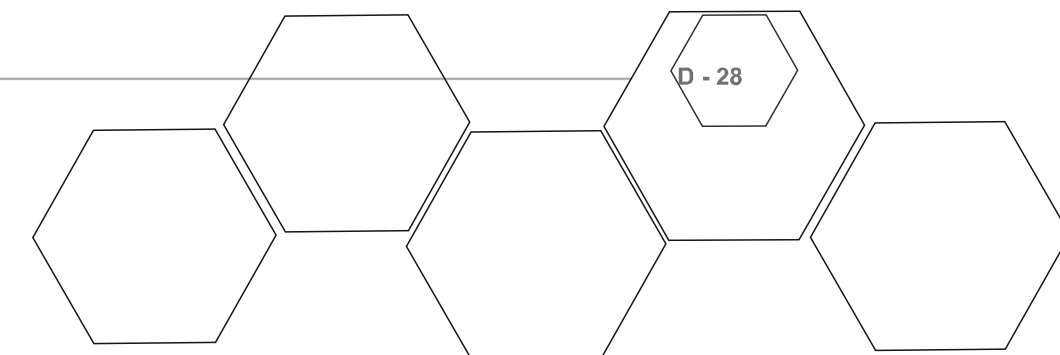

PSC Blank

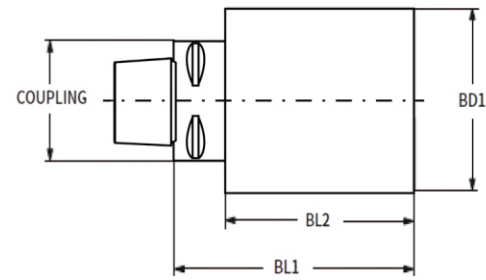

Technical parameters

Unit: mm

PSC size	Ordering code	BD1	BL1	Stock
PSC32	BLPSC32A040110M	40	110	▲
	BLPSC32A050110M	50	110	●
	BLPSC32A050125M	50	125	▲
	BLPSC32A070060M	70	60	▲
	BLPSC32A090070M	90	70	▲
PSC40	BLPSC40A040095M	40	95	▲
	BLPSC40A060130M	60	130	●
	BLPSC40A060165M	60	165	▲
	BLPSC40A080075M	80	75	▲
	BLPSC40A100085M	100	85	▲
PSC50	BLPSC50A050125M	50	125	●
	BLPSC50A075175M	75	175	●
	BLPSC50A090080M	90	80	▲
	BLPSC50A110090M	110	90	▲

PSC Blank

Technical parameters

Unit: mm

PSC size	Ordering code	BD1	BL1	Stock
PSC63	BLPSC63A072120M	72	120	●
	BLPSC63A075195M	75	195	●
	BLPSC63A100080M	100	80	●
	BLPSC63A110085M	110	85	▲
	BLPSC63A130095M	130	95	●
PSC80	BLPSC80A080200M	80	200	▲
	BLPSC80A120095M	120	95	▲
	BLPSC80A120160M	120	160	●
	BLPSC80A130090M	130	90	●

Availability: ● available in stock ▲ short lead time PSC blank have a 42-46HRC hardness front, which allows machining of special shapes

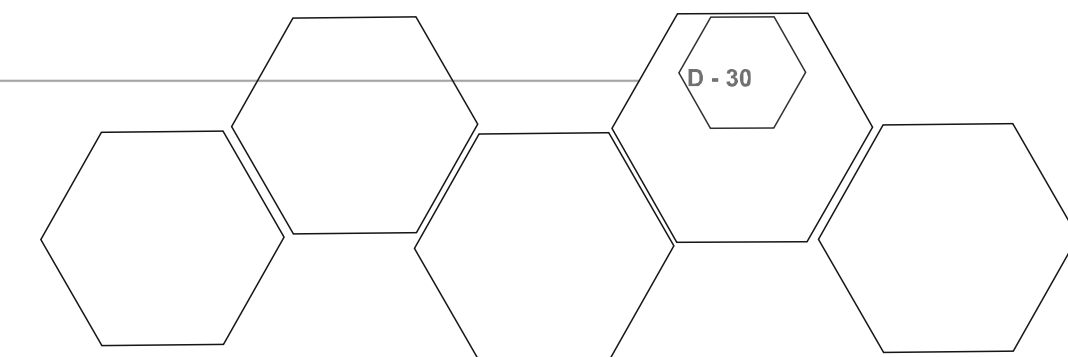

PSC CLAMPING UNIT

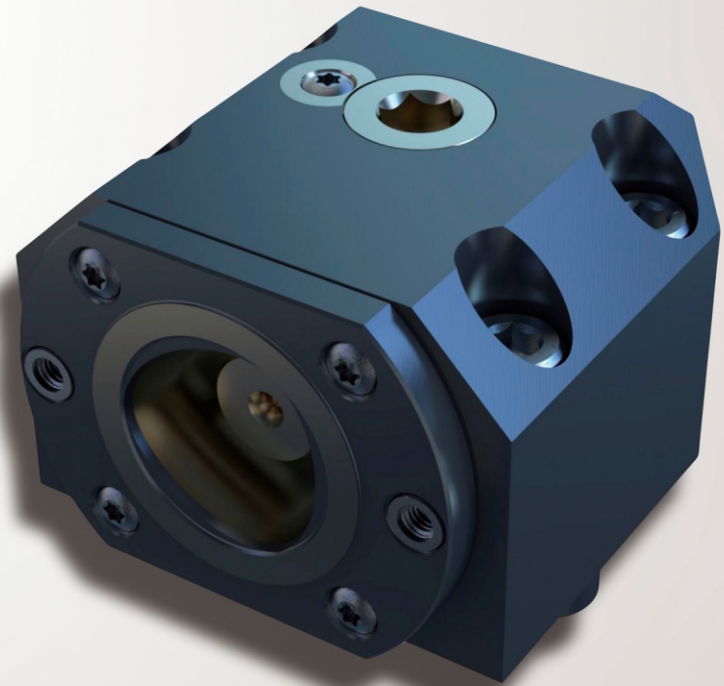

- Used with the turning tools with PSC interface;
- Realize the exchange of left and right hand tools;
- Cam locking device, change the tool swiftly.

D - 31

TOOLING ALSO ARTS

© Naming And Coding Rules

PSC	32
	40
	50
	63
	80

01. COUPLING TYPE



02. HAND OF TOOL

L	Left
R	Right

CUSA	General Purpose Receiver
CVDI	VDI Receiver
CSQUA	Horizontal Lathe Receiver

03. PRODUCT TYPE



04. SIZE

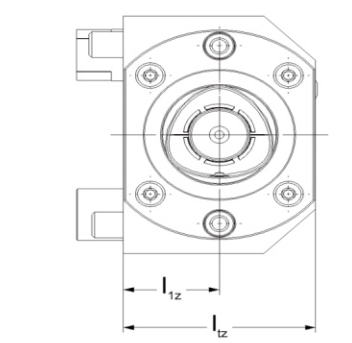

M	Standard
---	----------

06. FORMAT



05. SIZE

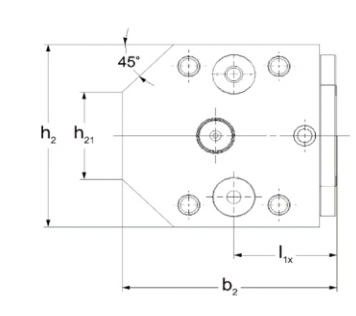

TOOLING ALSO ARTS

D - 32

CUSA

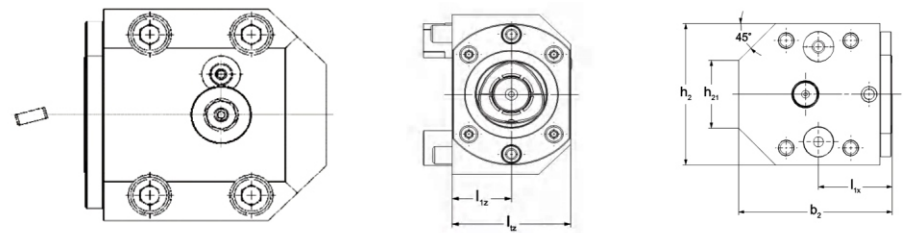

Technical parameters

Unit: mm

PSC size	Ordering code	b2	h2	h21	l1x	l1z	ltz	m (kg)
PSC32	PSC32RCUSA19039	73	54	30	39	19	38	1.3
PSC32	PSC32LCUSA19039	73	54	30	39	19	38	1.3
PSC40	PSC40RCUSA24043	86	77	38	43	24	48	2.26
PSC40	PSC40LCUSA24043	86	77	38	43	24	48	2.26
PSC50	PSC50RCUSA32048	100	92	44	48	32	64	3.74
PSC50	PSC50LCUSA32048	100	92	44	48	32	64	3.74
PSC63	PSC63RCUSA42060	122	105	37	60	42	84	7.1
PSC63	PSC63LCUSA42060	122	105	37	60	42	84	7.1
PSC80	PSC80RCUSA50088	146	133	133	88	50	100	13.25
PSC80	PSC80LCUSA50088	146	133	133	88	50	100	13.25

Clamping device R \ L Rusa application design description

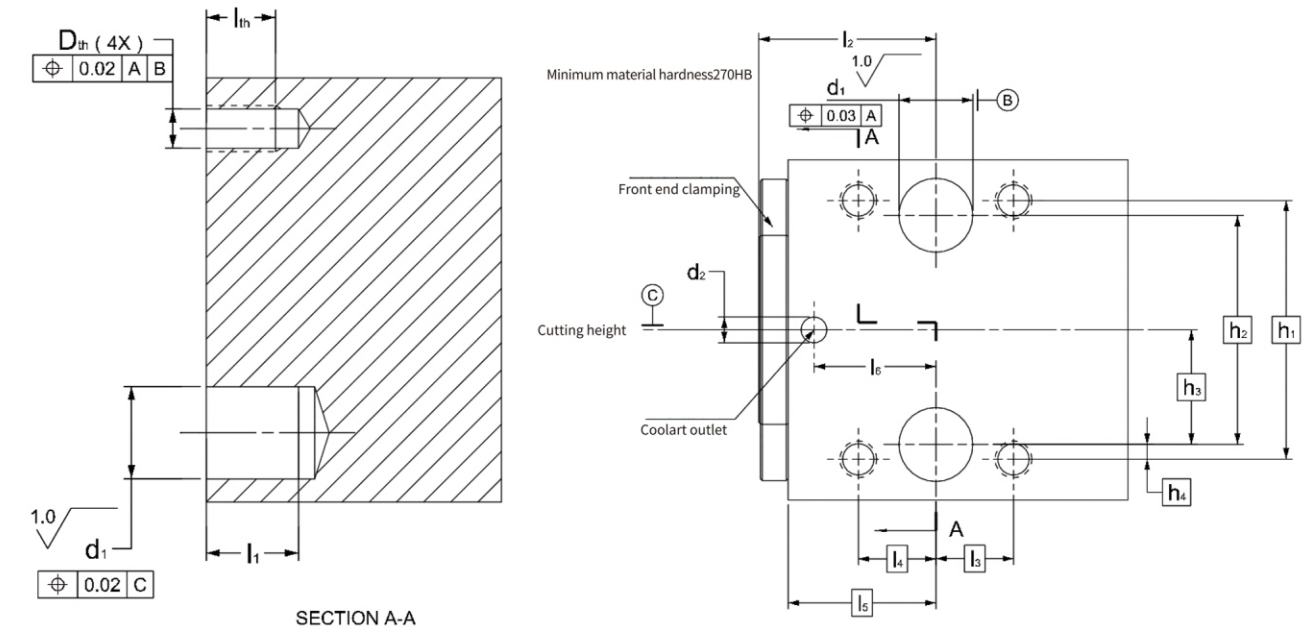

Technical parameters

Unit: mm

Clamping Device	d1(H7)	d2	h1	h2	h3	h4	l1(min)	l2	l3	l4	l5	l6	lth(min)	Dth
PSC32R\LCUSA19039	12	5	42	39	19.5	1.5	8.5	39	19	19	33.5	28	7.5	M6
PSC40R\LCUSA24043	16	7	60	55	27.5	2.5	11	43	19	19	36.5	30	11	M8
PSC50R\LCUSA32048	20	7	70	62	31	4	12	48	21	21	39.5	33	13	M10
PSC63R\LCUSA42060	25	10	82	71	35.5	5.5	20	60	24.5	24.5	50.5	41	12	M10
PSC80R\LCUSA50088	32	11	110	92	46	9	20	88	43	43	76	63	14.5	M12

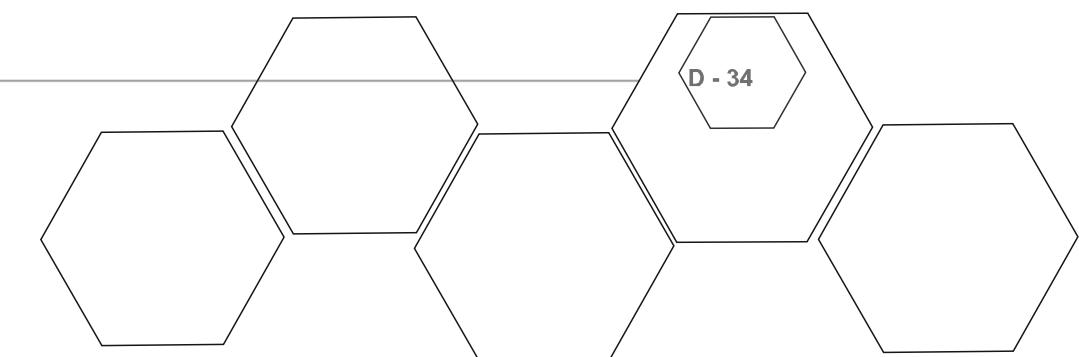

VDI External Receiver

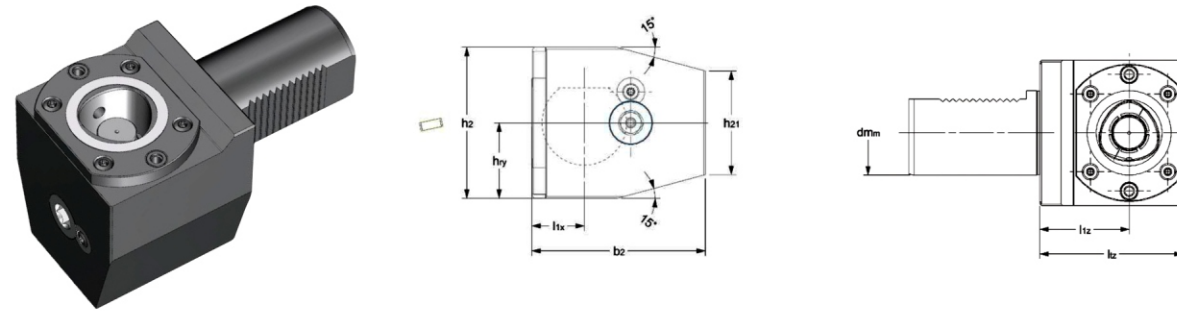

Technical parameters

Unit: mm

VDI size	PSC size	Ordering code	b2	hry	h2	h21	l1x	l1z	l1t	m (kg)
30	PSC32	PSC32-RCVDI30-41020M	74	30	57	38	20	41	60	2.1
30	PSC32	PSC32-LCVDI30-41020M	74	30	57	38	20	41	60	2.1
30	PSC32	PSC32-RCVDI30-41030M	73	30	57	41	30	41	60	2.2
30	PSC32	PSC32-LCVDI30-41030M	73	30	57	41	30	41	60	2.2
40	PSC40	PSC40-RCVDI40-51030M	86	38	75	54	30	51	75	3.2
40	PSC40	PSC40-LCVDI40-51030M	86	38	75	54	30	51	75	3.2
50	PSC40	PSC40-RCVDI50-51040M	86	38	75	60	40	51	75	3.2
50	PSC40	PSC40-LCVDI50-51040M	86	38	75	60	40	51	75	3.2
40	PSC50	PSC50-RCVDI40-53030M	99	41	82	47	30	53	85	5.7
40	PSC50	PSC50-LCVDI40-53030M	99	41	82	47	30	53	85	5.7
40	PSC50	PSC50-RCVDI40-53040M	99	41	82	53	40	53	85	5.7
40	PSC50	PSC50-LCVDI40-53040M	99	41	82	53	40	53	85	5.7
50	PSC50	PSC50-RCVDI50-41030M	86	43	86	66	30	41	65	5.7
50	PSC50	PSC50-LCVDI50-41030M	86	43	86	66	30	41	65	5.7
50	PSC50	PSC50-RCVDI50-53030M	99	43	86	59	30	53	85	5.7
50	PSC50	PSC50-LCVDI50-53030M	99	43	86	59	30	53	85	5.7
50	PSC50	PSC50-RCVDI50-53040M	99	43	86	65	40	53	85	5.7
50	PSC50	PSC50-LCVDI50-53040M	99	43	86	65	40	53	85	5.7
60	PSC50	PSC50-RCVDI60-43040M	99	53	94	76	40	43	75	5.7
60	PSC50	PSC50-LCVDI60-43040M	99	53	94	76	40	43	75	5.7
60	PSC63	PSC63-RCVDI60-53040M	122	53	105	70	40	53	95	6
60	PSC63	PSC63-LCVDI60-53040M	122	53	105	70	40	53	95	6

D - 35

TOOLING ALSO ARTS

VDI External Receiver

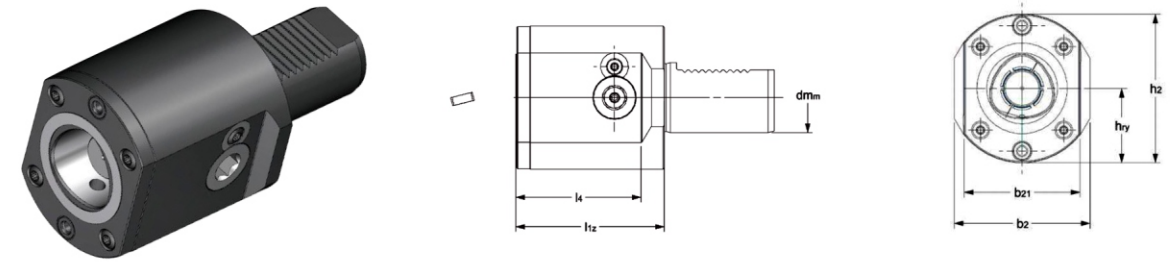

Technical parameters

Unit: mm

VDI size	PSC size	Ordering code	b21	b2	hry	h2	l1z	l4	m (kg)
30	PSC32	PSC32-RCVDI30-00060M	38	50	34	61	60	44	1
30	PSC32	PSC32-LCVDI30-00060M	38	50	34	61	60	44	1
40	PSC40	PSC40-RCVDI40-00075M	48	75	41	75	75	53	2.2
40	PSC40	PSC40-LCVDI40-00075M	48	75	41	75	75	53	2.2
50	PSC40	PSC40-RCVDI50-00065M	64	75	41	82	85	72	3.2
50	PSC40	PSC40-LCVDI50-00065M	64	75	41	82	85	72	3.2
40	PSC50	PSC50-RCVDI40-00085M	48	70	49	83	65	39	2.2
40	PSC50	PSC50-LCVDI40-00085M	48	70	49	83	65	39	2.2
50	PSC50	PSC50-RCVDI50-00085M	64	83	49	91	85	62	3.2
50	PSC50	PSC50-LCVDI50-00085M	64	83	49	91	85	62	3.2
60	PSC50	PSC50-RCVDI60-00075M	64	80	58	100	75	56	5.7
60	PSC50	PSC50-LCVDI60-00075M	64	80	58	100	75	56	5.7
60	PSC63	PSC63-RCVDI60-00095M	84	84	58	111	95	50	6.1
60	PSC63	PSC63-LCVDI60-00095M	84	84	58	111	95	50	6.1

TOOLING ALSO ARTS

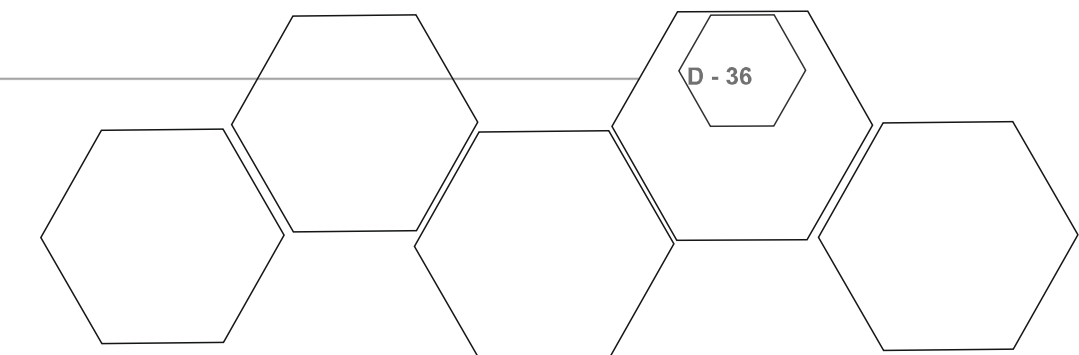

Horizontal Lathe Receiver

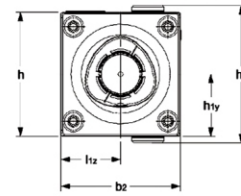
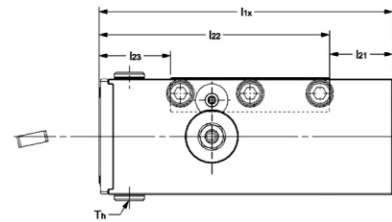

Technical parameters

Unit: mm

PSC size	Ordering code	b2	h1y	h2	l1x	l1z	l21	l22	l23	Th	m (kg)
PSC32	PSC32-RCSQUA-4038M	38	20	62	95	19	16.5	78.5	25	G1/8	1.3
PSC32	PSC32-LCSQUA-4038M	38	20	62	95	19	16.5	78.5	25	G1/8	1.3
PSC40	PSC40-RCSQUA-5048M	48	25	54	125	24	24	101	30.5	G1/8	2.3
PSC40	PSC40-LCSQUA-5048M	48	25	54	125	24	24	101	30.5	G1/8	2.3
PSC50	PSC50-RCSQUA-6464M	64	32	68	145	32	27	118	36	G1/8	3.2
PSC50	PSC50-LCSQUA-6464M	64	32	68	145	32	27	118	36	G1/8	3.2

TOOL HOLDER ADAPTOR

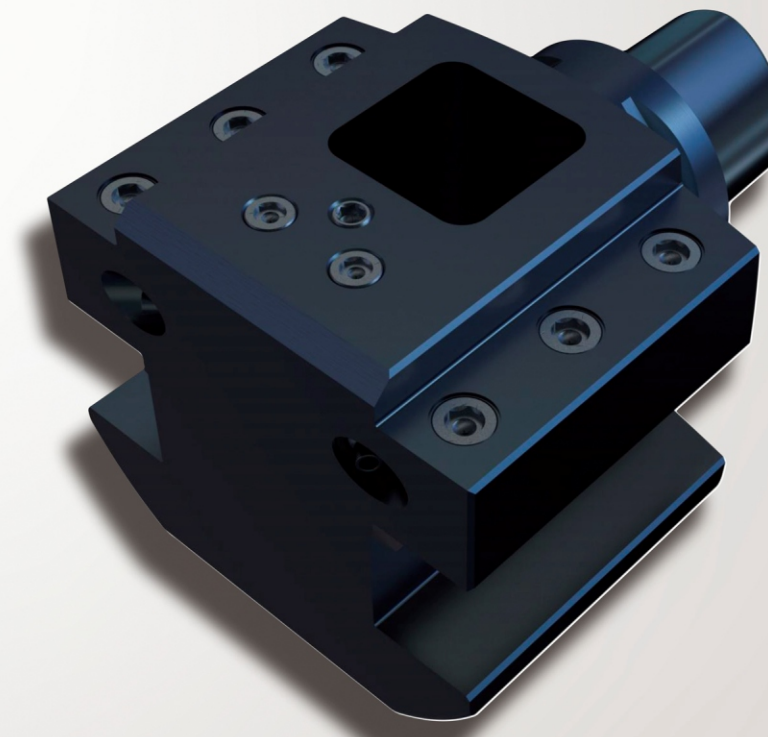

- Can be used with traditional square tool holders;
- Reduce the tool cost;
- No need downtime to adjust the tool;
- Can be applied from multiple angles.

General Purpose 90° Adaptor

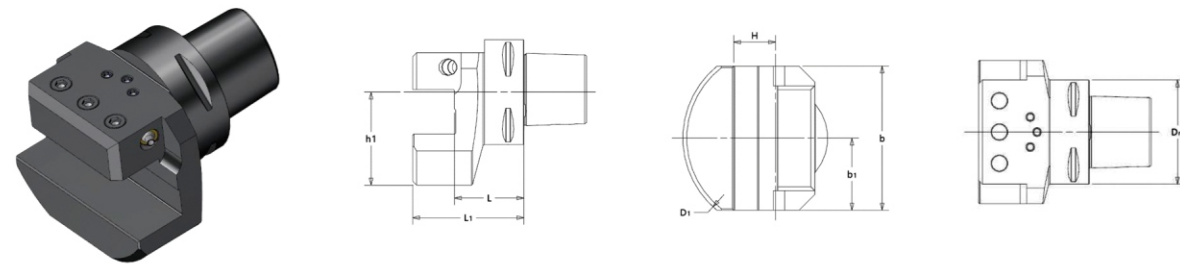

Technical parameters

Unit: mm

PSC size	Square size	Ordering code	Dm	L1	L	H	b	D1	h1	b1	m (kg)	Screw
PSC50	20X20	PSC50-ASHA-065-20	50	65	45	20	64	85	37	32	1.4	251.120.20
PSC63	20X20	PSC63-ASHA-070-20	63	70	50	20	64	85	37	32	1.8	251.120.20
PSC63	25X25	PSC63-ASHA-080-25	63	80	55	25	76	100	46	38	2.4	251.120.20
PSC80	25X25	PSC80-ASHA-075-25	80	75	50	25	80	103	46	38	3.1	251.120.20
PSC80	32X32	PSC80-ASHA-085-32	80	85	53	32	110	142	65	55	4.4	251.120.20

General Purpose 0° Both-sides Adaptor

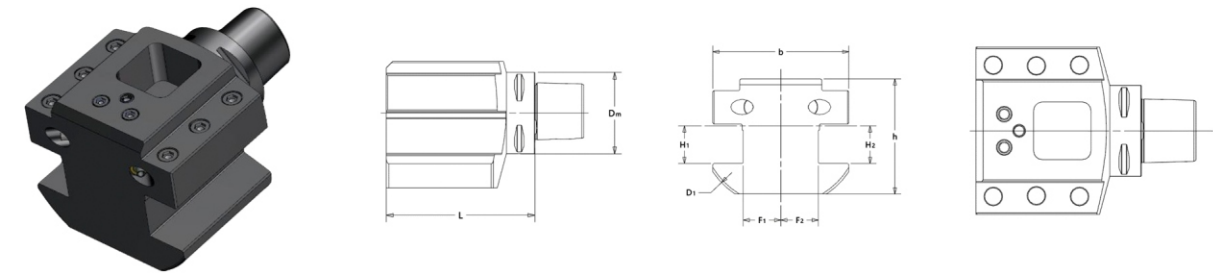

Technical parameters

Unit: mm

PSC size	Square size	Ordering code	Dm	L1	L2	F1	F2	H1	H2	b	h	D1	m (kg)	Screw
PSC63	25X25	PSC63-ASHS-122-25	63	122	122	20	20	25	25	90	78	114	4.5	251.120.20
PSC80	25X25	PSC80-ASHS-122-25	80	122	122	30	30	25	25	110	75	128	5.9	251.120.20

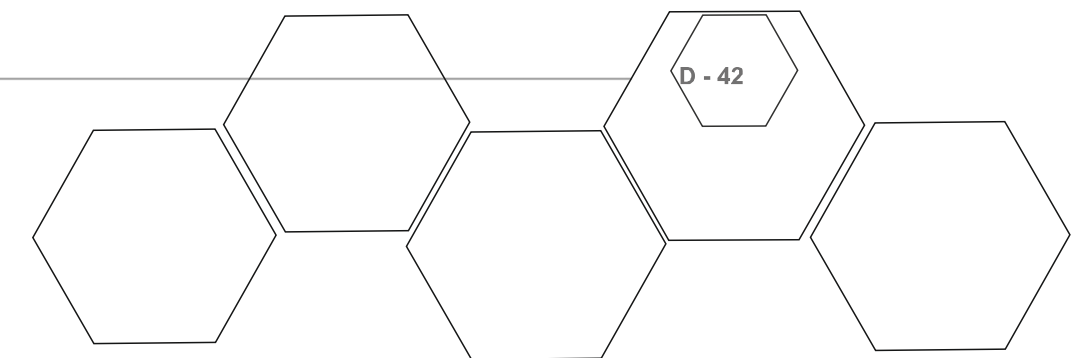

© Naming And Coding Rules

PSC	32
	40
	50
	63
	80

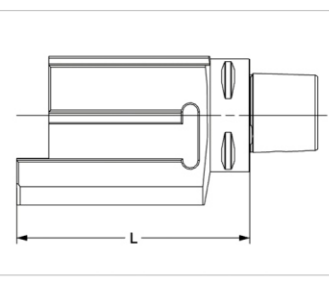

01. COUPLING TYPE



03. LENGTH



03. PRODUCT TYPE

ASHL	General Purpose 0° Left-Hand Adaptor
ASHR	General Purpose 0° Right-Hand Adaptor
ASHA	Purpose 90° Adaptor
ASHS	Purpose 0° Both-sides Adaptor

04. HEIGHT

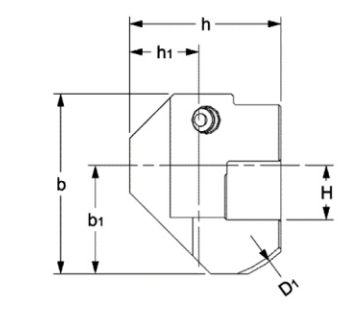

General Purpose 0° Adaptor

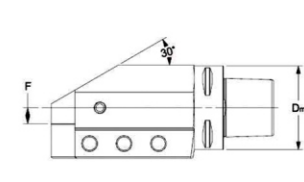
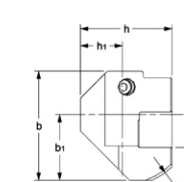
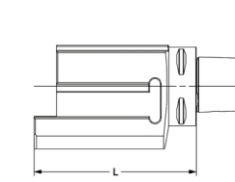

Technical parameters

Unit: mm

PSC size	Square size	Ordering code	Dm	L	F	H	b	h	D1	h1	b1	m (kg)	Screw
PSC50	20X20	PSC50-ASHR-095-20	50	95	10	20	55.5	69	85	37	30	1.69	251.080.20
PSC50	20X20	PSC50-ASHL-095-20	50	95	10	20	55.5	69	85	37	30	1.69	251.080.20
PSC63	20X20	PSC63-ASHR-105-20	63	105	10	20	63.5	69	85	37	30	2.39	251.080.20
PSC63	20X20	PSC63-ASHL-105-20	63	105	10	20	63.5	69	85	37	30	2.39	251.080.20
PSC63	25X25	PSC63-ASHR-122-25	63	122	13	25	70	78	100	46	38	3.17	251.100.18
PSC63	25X25	PSC63-ASHL-122-25	63	122	13	25	70	78	100	46	38	3.17	251.100.18
PSC80	25X25	PSC80-ASHR-122-25	80	122	15	25	80	86	103	46	40	4.06	251.100.20
PSC80	25X25	PSC80-ASHL-122-25	80	122	15	25	80	86	103	46	40	4.06	251.100.20
PSC80	32X32	PSC80-ASHR-140-32	80	140	8	32	80	95	110	55	40	5.13	251.120.30
PSC80	32X32	PSC80-ASHL-140-32	80	140	8	32	80	95	110	55	40	5.13	251.120.30

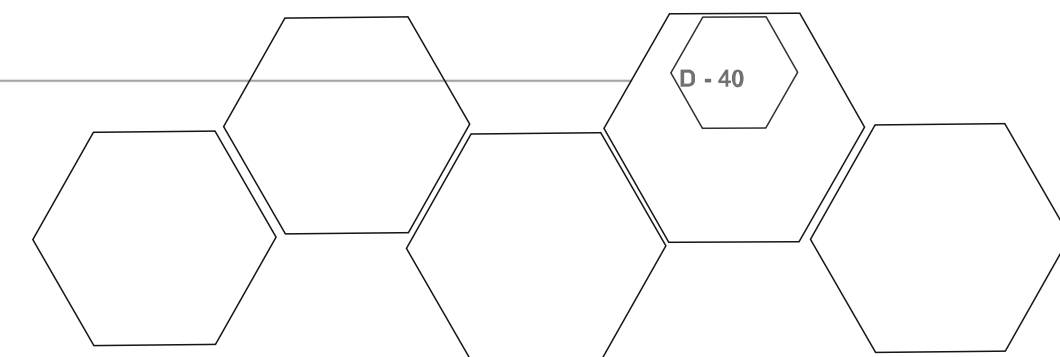

ADAPTOR



- Stronger transmission torque and stability with PSC interface;
- Modular structure of holder;
- More easy to maintain;
- Prolong the service life;
- Provide quick-change function.

D - 43

TOOLING ALSO ARTS

© Naming And Coding Rules

PSC	32	Arbor	A16A
	40		A22A
	50		A27A
	63		A32A
	80		A40A
			A40C
			A60C

02. ADAPTER TYPE

PSC40
01

PSC40
02

080
03

M
04

M	Standard
A	Short

04. FORMAT

01. COUPLING TYPE

PSC	32	BT	30
	40		40
	50		50
	63		50
	80		63
		HSK	80
			100

03. LENGTH

25	25mm	65	25mm	125	125mm
30	30mm	70	30mm	135	135mm
32	32mm	75	32mm	140	140mm
33	33mm	80	33mm	145	145mm
35	35mm	85	35mm	150	150mm
40	40mm	90	40mm	155	155mm
45	45mm	95	45mm	175	175mm
50	50mm	100	50mm	185	185mm
55	55mm	110	55mm	200	200mm
60	60mm	120	60mm		

TOOLING ALSO ARTS

D - 44

PSC Extension Adaptor

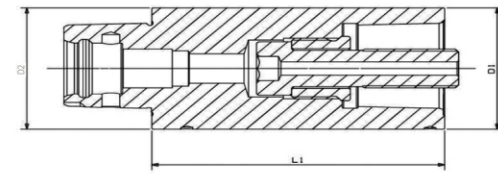

Technical parameters

Unit: mm

Ordering code	D1	D2	L1	m (kg)
PSC32-PSC32-035A	32	32	35	0.22
PSC32-PSC32-060M	32	32	60	0.36
PSC32-PSC32-080M	32	32	80	0.47
PSC32-PSC32-095M	32	32	95	0.56
PSC40-PSC40-040A	40	40	40	0.4
PSC40-PSC40-060M	40	40	60	0.57
PSC40-PSC40-080M	40	40	80	0.7
PSC40-PSC40-120M	40	40	120	1.11
PSC50-PSC50-050A	50	50	50	0.73
PSC50-PSC50-080M	50	50	80	1.15
PSC50-PSC50-100M	50	50	100	1.38
PSC50-PSC50-150M	50	50	150	2.17
PSC63-PSC63-060A	63	63	60	1.36

D - 45

TOOLING ALSO ARTS

PSC Extension Adaptor

Technical parameters

Unit: mm

Ordering code	D1	D2	L1	m (kg)
PSC63-PSC63-100M	63	63	100	2.26
PSC63-PSC63-140M	63	63	140	3.17
PSC63-PSC63-185M	63	63	185	4.19
PSC80-PSC80-065A	80	80	65	2.41
PSC80-PSC80-100M	80	80	100	3.7
PSC80-PSC80-125M	80	80	125	4.64
PSC80-PSC80-200M	80	80	200	7.47

Main spare parts(M)

PSC size	Threaded sleeve	Pull stud	Key
PSC32	SRLM1815155123	SCFM1215D16050	241.080.00
PSC40	SRLM2215175143	SCFM1415D19057	241.080.00
PSC50	SRLM2515200163	SCFM1615D22069	241.100.00
PSC63	SRLM3015240203	SCFM2020D27087	241.140.00
PSC80	SRLM3015240203	SCFM2020D27087	241.140.00

The spare parts can be ordered separately. Please inquire on demand.

Main spare parts(A)

PSC size	Pull stud	SOFTOOL	Key
PSC32-PSC32-035A	512.068.01	545.040.02	241.080.00
PSC40-PSC40-040A	512.068.02	545.040.03	241.080.00
PSC50-PSC50-050A	512.068.03	545.040.07	241.080.00
PSC63-PSC63-060A	512.068.04	545.040.08	241.140.00
PSC80-PSC80-065A	512.068.05	545.040.08	241.140.00

TOOLING ALSO ARTS

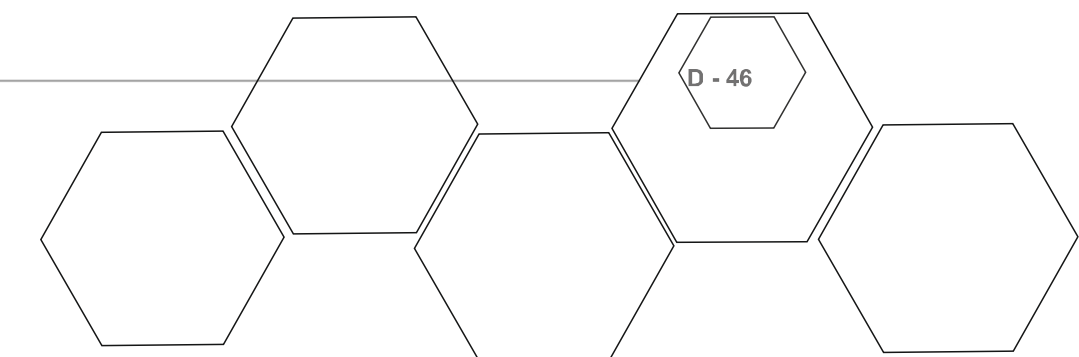

PSC Reduction Adaptor

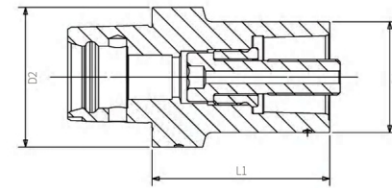

Technical parameters

Unit: mm

Ordering code	D1	D2	L1	m (kg)
PSC40-PSC32-055M	32	40	55	0.49
PSC40-PSC32-070M	32	40	70	0.59
PSC40-PSC32-120M	32	40	120	0.81
PSC50-PSC32-033A	32	50	33	0.54
PSC50-PSC32-060M	32	50	60	0.68
PSC50-PSC32-120M	32	50	120	0.99
PSC50-PSC32-150M	32	50	150	1.65
PSC50-PSC40-040A	40	50	40	0.59
PSC50-PSC40-065M	40	50	65	0.8
PSC50-PSC40-085M	40	50	85	1.1
PSC50-PSC40-140M	40	50	140	1.46
PSC63-PSC32-032A	32	63	32	0.91
PSC63-PSC32-070M	32	63	70	1.12
PSC63-PSC32-125M	32	63	125	1.43
PSC63-PSC32-185M	32	63	185	2.99
PSC63-PSC40-040A	40	63	40	0.98
PSC63-PSC40-080M	40	63	80	1.32
PSC63-PSC40-145M	40	63	145	1.86
PSC63-PSC40-185M	40	63	185	3.23
PSC63-PSC50-050A	50	63	50	1.11

D - 47

TOOLING ALSO ARTS

PSC Reduction Adaptor

Technical parameters

Unit: mm

Ordering code	D1	D2	L1	m (kg)
PSC63-PSC50-080M	50	63	80	1.53
PSC63-PSC50-110M	50	63	110	2.23
PSC63-PSC50-175M	50	63	175	2.79
PSC80-PSC32-060M	32	80	60	2.07
PSC80-PSC32-135M	32	80	135	2.53
PSC80-PSC40-070M	40	80	70	2.2
PSC80-PSC40-155M	40	80	155	2.97
PSC80-PSC40-200M	40	80	200	5.42
PSC80-PSC50-045A	50	80	45	2
PSC80-PSC50-080M	50	80	80	2.43
PSC80-PSC50-185M	50	80	185	3.88
PSC80-PSC50-200M	50	80	200	5.84
PSC80-PSC63-055A	63	80	55	2.15
PSC80-PSC63-080M	63	80	80	2.65
PSC80-PSC63-120M	63	80	120	4.1
PSC80-PSC63-200M	63	80	200	5.37

Main spare parts(M)

PSC size	Threaded sleeve	Pull stud	Key
PSC32	SRLM1815155123	SCFM1215D16050	241.080.00
PSC40	SRLM2215175143	SCFM1415D19057	241.080.00
PSC50	SRLM2515200163	SCFM1615D22069	241.100.00
PSC63	SRLM3015240203	SCFM2020D27087	241.140.00
PSC80	SRLM3015240203	SCFM2020D27087	241.140.00

The spare parts can be ordered separately. Please inquire on demand.

Main spare parts(A)

PSC size	Pull stud	SOFTOOL	Key
PSC50-PSC32-033A	512.068.01	545.040.02	241.080.00
PSC50-PSC40-040A	512.068.06	545.040.07	241.080.00
PSC63-PSC32-032A	512.068.01	545.040.02	241.080.00
PSC63-PSC40-040A	512.068.02	545.040.03	241.080.00
PSC63-PSC50-050A	512.068.07	545.040.08	241.100.00
PSC80-PSC50-045A	512.068.08	545.040.08	241.100.00
PSC80-PSC63-055A	512.068.05	545.040.08	241.140.00

TOOLING ALSO ARTS

D - 48

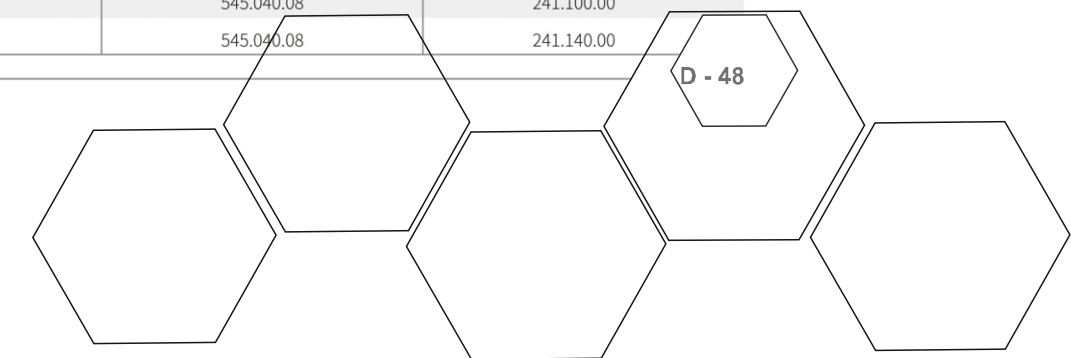

PSC with Arbor Adaptor

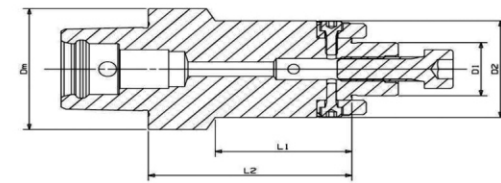

Technical parameters

Unit: mm

Ordering code	Dm	D1	D2	L1	L2	m (kg)
PSC32-A16A-030M	32	16	32	15	30	0.25
PSC40-A16A-032M	40	16	32	10	32	0.38
PSC40-A16A-055M	40	16	32	33	55	0.4
PSC40-A22A-025M	40	22	40	-	25	0.4
PSC40-A22A-055M	40	22	40	25	55	0.6
PSC50-A16A-035M	50	16	32	10	35	0.6
PSC50-A16A-070M	50	16	32	45	70	0.7
PSC50-A22A-025M	50	22	50	-	25	0.62
PSC50-A22A-070M	50	22	40	47	70	0.9
PSC50-A27A-025M	50	27	50	-	25	0.68
PSC50-A32A-040M	50	32	63	20	40	1.14
PSC63-A16A-040M	63	16	32	10	40	1
PSC63-A22A-025M	63	22	50	-	25	0.96
PSC63-A22A-080M	63	22	40	40	80	1.4
PSC63-A27A-025M	63	27	50	-	25	1.01
PSC63-A27A-080M	63	27	50	55	80	1.6

D - 49

TOOLING ALSO ARTS

PSC with Arbor Adaptor

Technical parameters

Unit: mm

Ordering code	Dm	D1	D2	L1	L2	m (kg)
PSC63-A32A-025M	63	32	63	-	25	1.09
PSC63-A40A-045M	63	40	70	20	45	1.75
PSC63-A40C-050M	63	40	88	28	50	2.4
PSC80-A16A-050M	80	16	32	10	50	2.1
PSC80-A22A-030M	80	22	80	-	30	1.86
PSC80-A22A-090M	80	22	40	45	90	2.4
PSC80-A27A-030M	80	27	50	-	30	1.91
PSC80-A27A-090M	80	27	50	50	90	2.7
PSC80-A32A-030M	80	32	80	-	30	2.02
PSC80-A40A-030M	80	40	80	-	30	2
PSC80-A40C-060M	80	40	88	30	60	3.47
PSC80-A60C-080M	80	60	130	50	80	7.78

Main spare parts

Arbor size	Key block	Key block screw	Screw	Washer	Key block key	Key
A16A	141.011.04	113.030.06	120.080.25	-	241.025.56	241.060.90
A22A	141.011.01	113.040.10	120.100.35	-	241.030.63	241.080.00
A27A	141.010.01	113.040.12	120.120.35	133.120.30	241.030.63	241.100.00
A32A	141.010.04	-	120.160.40	133.160.30	241.040.70	241.140.00
A40A	141.010.02	113.060.15	120.200.45	133.200.40	241.050.80	241.170.00
A40C	142.010.02	113.060.20	113.120.40	-	241.050.80	241.100.00
A60C	141.011.02	113.120.25	113.160.50	-	241.100.00	241.140.00

The spare parts can be ordered separately. Please inquire on demand.

TOOLING ALSO ARTS

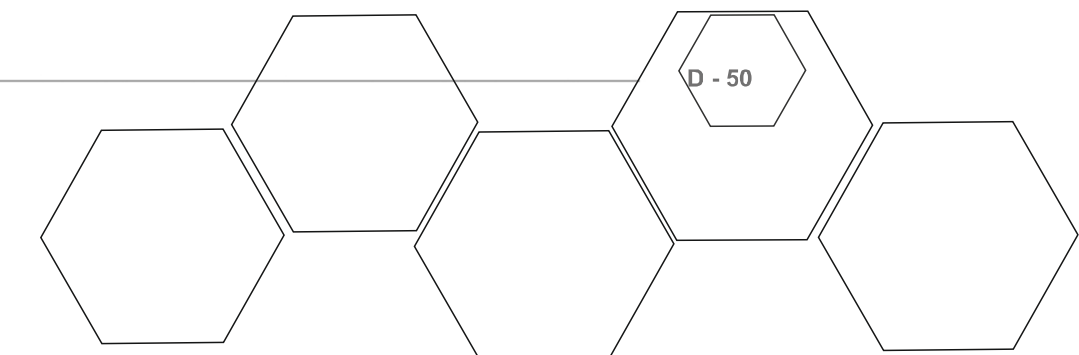

BT with Type PSC Adaptor

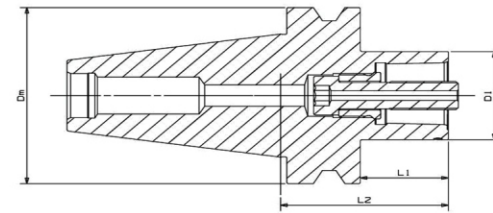

Technical parameters

Unit: mm

Ordering code	Dm	D1	L2	L1	m (kg)
BT30-PSC32-030M	46	32	30	8	0.42
BT30-PSC32-060M	46	32	60	38	0.58
BT30-PSC40-060M	46	40	60	38	0.67
BT30-PSC50-080M	46	50	80	58	1.08
BT40-PSC32-030M	63	32	30	3	1
BT40-PSC32-060M	63	32	60	33	0.99
BT40-PSC40-030M	63	40	30	3	0.95
BT40-PSC40-060M	63	40	60	33	1.21
BT40-PSC50-030M	63	50	30	3	3.56
BT40-PSC50-070M	63	50	70	43	4.09
BT40-PSC63-075M	63	63	75	48	1.75
BT50-PSC32-040M	100	32	40	2	3.72
BT50-PSC32-070M	100	32	70	32	3.82
BT50-PSC40-040M	100	40	40	2	3.72
BT50-PSC40-070M	100	40	70	32	3.9
BT50-PSC50-040M	100	50	40	2	3.59

BT with Type PSC Adaptor

Technical parameters

Unit: mm

Ordering code	Dm	D1	L2	L1	m (kg)
BT50-PSC50-080M	100	50	80	42	4.13
BT50-PSC63-040M	100	63	40	2	3.61
BT50-PSC63-090M	100	63	90	52	4.71
BT50-PSC80-070M	100	80	70	32	4.16
BT50-PSC80-120M	100	80	120	82	6.02

Main spare parts

PSC size	Threaded sleeve	Pull stud	Key
PSC32	SRM1815155123	SCFM1215D16050	241.080.00
PSC40	SRM2215175143	SCFM1415D19057	241.080.00
PSC50	SRM2515200163	SCFM1615D22069	241.100.00
PSC63	SRM3015240203	SCFM2020D27087	241.140.00
PSC80	SRM3015240203	SCFM2020D27087	241.140.00

The spare parts can be ordered separately. Please inquire on demand.

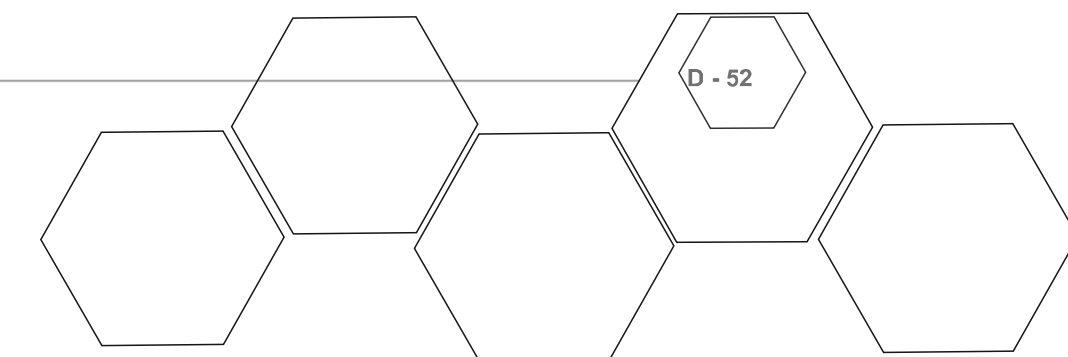

HSK with Type PSC Adaptor

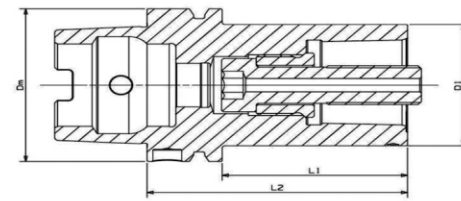

Technical parameters

Unit: mm

Ordering code	D1	L2	L1	Dm	m (kg)
HSK50A-PSC32-075M	32	75	49	50	0.67
HSK50A-PSC40-080M	40	80	54	50	0.85
HSK63A-PSC32-075M	32	75	49	63	0.97
HSK63A-PSC40-080M	40	80	54	63	1.14
HSK63A-PSC50-090M	50	90	64	63	1.47
HSK80A-PSC40-090M	40	90	64	80	1.69
HSK80A-PSC50-095M	50	95	69	80	2.02
HSK80A-PSC63-110M	63	110	84	80	2.79
HSK100A-PSC32-080M	32	80	43	100	2.42
HSK100A-PSC40-090M	40	90	61	100	2.63
HSK100A-PSC50-100M	50	100	71	100	3.02
HSK100A-PSC63-110M	63	110	81	100	3.7
HSK100A-PSC80-120M	80	120	91	100	4.87

D - 53

TOOLING ALSO ARTS

HSK with Type PSC Adaptor

Main spare parts

PSC size	Threaded sleeve	Pull stud	Key
PSC32	SRLM1815155123	SCFM1215D16050	241.080.00
PSC40	SRLM2215175143	SCFM1415D19057	241.080.00
PSC50	SRLM2515200163	SCFM1615D22069	241.100.00
PSC63	SRLM3015240203	SCFM2020D27087	241.140.00
PSC80	SRLM3015240203	SCFM2020D27087	241.140.00

The spare parts can be ordered separately. Please inquire on demand.

TOOLING ALSO ARTS

